

USER MANUAL



CONTENTS

1. SAFETY INFORMATION.....	3
2. CONDITIONS OF USE.....	4
3. SAFETY INSTRUCTIONS.....	4
4. INSTALLATION.....	6
5. PRODUCT DESCRIPTION.....	10
6. THE WATER SOFTENER (SOFTWATER TECHNOLOGY).....	12
7. CONTROL PANEL.....	15
8. FIRST TIME START-UP.....	16
9. TOUCH SCREEN.....	18
10. BEFORE FIRST USE.....	19
11. PROGRAMMES.....	20
12. OPTIONS.....	25
13. DAILY USE.....	29
14. SETTINGS.....	34
15. HINTS AND TIPS.....	38
16. CARE AND CLEANING.....	39
17. TROUBLESHOOTING.....	44
18. TECHNICAL DATA.....	48
19. ACCESSORIES.....	49
20. WARRANTY.....	50

FOR PERFECT RESULTS

Thank you for choosing this AEG product. We have created it to give you impeccable performance for many years, with innovative technologies that help make life simpler features you might not find on ordinary appliances. Please spend a few minutes reading to get the very best from it.

Visit our website for:



Get usage advice, brochures, trouble shooter, service information:
www.aeg.com/webselfservice



Register your product for better service:
www.registeraeg.com

CUSTOMER CARE AND SERVICE

Always use original spare parts.

When contacting our Authorised Service Centre, ensure that you have the following data available: Model, PNC, Serial Number.

The information can be found on the rating plate.

 Warning / Caution-Safety information

 General information and tips

 Environmental information

Subject to change without notice.

1. SAFETY INFORMATION

Before the installation and use of the appliance, carefully read the supplied instructions. The manufacturer is not responsible for any injuries or damages that are the result of incorrect installation or usage. Always keep the instructions in a safe and accessible location for future reference.

1.1 Children and vulnerable people safety

- This appliance can be used by children aged from 8 years and above and persons with reduced physical, sensory or mental capabilities or lack of experience and knowledge if they have been given supervision or instruction concerning the use of the appliance in a safe way and understand the hazards involved.
- Children between 3 and 8 years of age and persons with very extensive and complex disabilities shall be kept away unless continuously supervised.
- Children of less than 3 years of age should be kept away unless continuously supervised.
- Do not let children play with the appliance.
- Keep all packaging away from children and dispose of it appropriately.
- Keep detergents away from children.
- Keep children and pets away from the appliance when the door is open.
- Children shall not carry out cleaning and user maintenance of the appliance without supervision.

1.2 General Safety

- Do not change the specification of this appliance.
- Do not exceed the maximum load of 10 kg (refer to the "Programme chart" chapter).
- The operating water pressure at the water entry point from the outlet connection must be between 0.5 bar (0.05 MPa) and 8 bar (0.8 MPa).

- The ventilation opening in the base must not be covered by a carpet, mat, or any floor covering.
- The appliance must be connected to the water mains using the new supplied hose sets, or other new hose sets supplied by the Authorised Service Centre.
- Old hose sets must not be reused.
- If the mains power supply cable is damaged, it must be replaced by the manufacturer, its Authorised Service Centre or similarly qualified persons to avoid an electrical hazard.
- Before any maintenance operation, deactivate the appliance and disconnect the mains plug from the socket.
- Do not use high pressure water sprays and/or steam to clean the appliance.
- Clean the appliance with a moist cloth. Use only neutral detergents. Do not use abrasive products, abrasive cleaning pads, solvents or metal objects.

2. CONDITIONS OF USE

This appliance is intended to be used in household and similar applications such as:

- Farm houses

- By clients in serviced apartments, holiday apartments and other residential type environments.

3. SAFETY INSTRUCTIONS

3.1 Installation



The installation must comply with relevant national regulations.

- Remove all the packaging and the transit bolts.
- Keep the transit bolts in a safe place. If the appliance is to be moved in the future they must be reattached to lock the drum to prevent an internal damage.
- Always take care when moving the appliance as it is heavy. Always use safety gloves and enclosed footwear.
- Do not install or use a damaged appliance.
- Follow the installation instructions supplied with the appliance.
- Do not install or use the appliance where the temperature can be less than 0°C or where it is exposed to the weather.
- The floor area on which the appliance is to be installed must be flat, stable, heat resistant and clean.
- Make sure that there is air circulation between the appliance and the floor.
- Do not install the appliance directly above a floor drain.
- Adjust the feet to have the necessary space between the appliance and the flooring.

- Do not install the appliance where the appliance door cannot be fully opened.
- Do not put a container to collect possible water leakage under the appliance. Contact the Authorised Service Centre to ensure which accessories can be used.
- You can extend the drain hose to maximum 400 cm. Contact the service centre for the other drain hose and the extension.

3.2 Electrical connection



WARNING!

Risk of fire and electric shock.

- The appliance must be earthed.
- Always use a correctly installed shockproof socket.
- Make sure that the parameters on the rating plate are compatible with the electrical ratings of the mains power supply.
- Do not use multi-plug adapters and extension cables.
- Make sure not to cause damage to the mains plug and to the mains cable. Should the mains cable need to be replaced, this must be carried out by our Authorised Service Centre.
- Connect the mains plug to the mains socket only at the end of the installation. Make sure that there is access to the mains plug after the installation.
- Do not touch the mains cable or the mains plug with wet hands.
- Do not pull the mains cable to disconnect the appliance. Always pull the mains plug.

3.3 Water connection

- Do not cause damage to the water hoses.
- Before connection to new pipes, pipes not used for a long time, where repair work has been carried out or new devices fitted (water meters, etc.), let the water flow until it is clean and clear.
- Ensure that there are no visible water leaks during and after the first use of the appliance.
- Do not use an extension hose if the inlet hose is too short. Contact the service centre for the replacement of the inlet hose.

3.4 Use



WARNING!

Risk of injury, electric shock, fire, burns or damage to the appliance.

- This appliance is for household use only.
- Follow the safety instructions on the detergent packaging.
- Do not put flammable products or items that are wet with flammable products in, near or on the appliance.
- Make sure that all metal objects are removed from the laundry.
- Do not wash fabrics which are heavily soiled with oil, grease or other greasy substances. It can damage rubber parts of the washing machine. Prewash such fabrics by hand before loading them into the washing machine.
- Do not touch the glass door while a programme is in operation. The glass can get hot.

3.5 Service

- To repair the appliance contact an Authorised Service Centre.
- Use original spare parts only.

3.6 Disposal



WARNING!

Risk of injury or suffocation.

- Disconnect the appliance from the mains electrical and water supplies.
- Cut off the mains electrical cable close to the appliance and dispose of it.
- Remove the door catch to prevent children or pets from becoming trapped in the drum.
- Dispose of the appliance in accordance with local requirements for the disposal of Waste Electrical and Electronic Equipment (WEEE).

4. INSTALLATION



WARNING!
Refer to Safety chapters.

4.1 Unpacking



WARNING!
Remove all the packaging and the transit bolts before installing the appliance.



WARNING!
Use the gloves.

1. Remove the external film. If necessary, use a cutter.

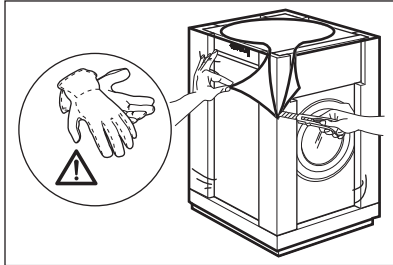

2. Remove the cardboard top and the polystyrene packaging materials.

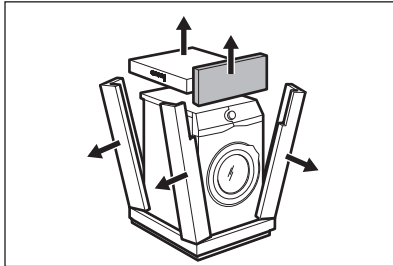

3. Remove the internal film.

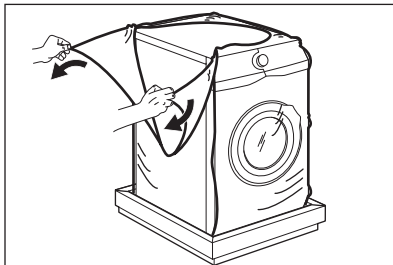

4. Open the door and remove the polystyrene piece from the door seal and all the items from the drum.

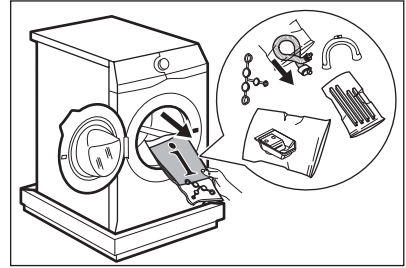

5. Carefully put down the appliance with the rear side on it.
6. Put the front polystyrene packaging element on the floor under the appliance.

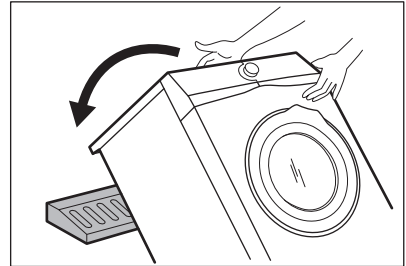

Make sure not to damage the hoses.

7. Remove the polystyrene protection from the bottom.

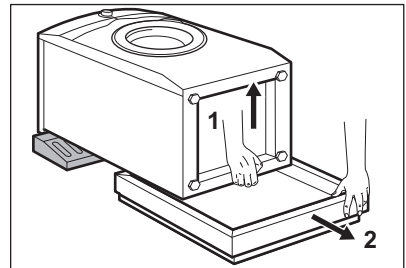

8. Fully clean and dry the bottom of the appliance.

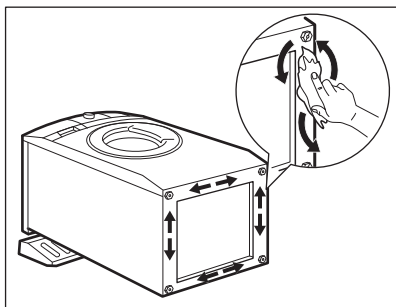

CAUTION!

Do not use alcohol, solvents or chemical products.

9. Make sure to identify the different sizes and the positions of the sound barriers. Refer to the illustration:

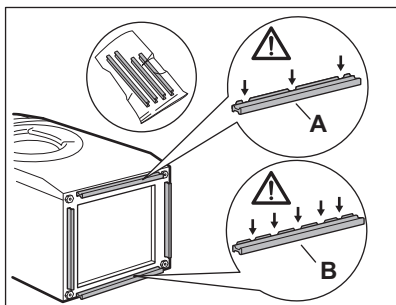

- **A (FRONT)** = Front of the appliance
- **B (BACK)** = Rear of the appliance

10. Remove the adhesive strip from the silent barriers.
11. Attach the four barriers to bottom of the appliance.
12. Refer to the illustration. Make sure that the barriers are securely attached.

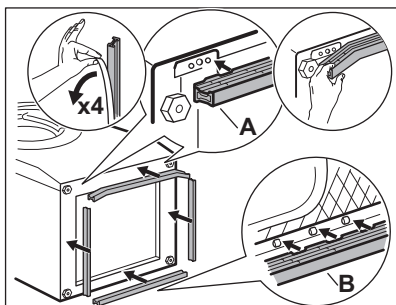

Attach the sound barriers at a room temperature.

13. Pull up the appliance in vertical position.

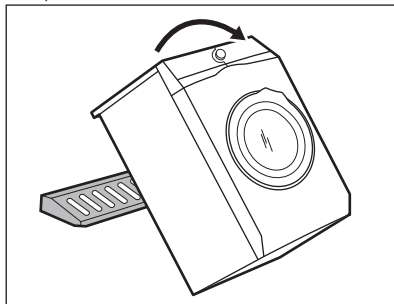

14. Remove the power supply cable and the drain hose from the hose holders.

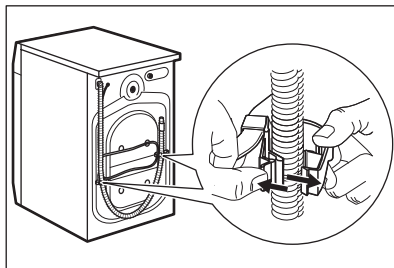

It is possible to see water flowing from the drain hose. This is due to the testing with water of the appliance in factory.

15. Remove the three bolts with the key supplied with the appliance.

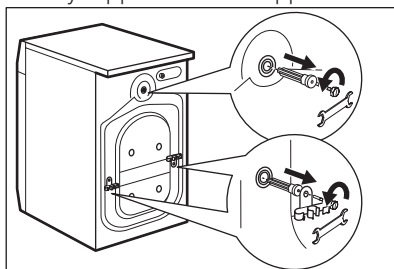

16. Pull out the plastic spacers.
17. Put the plastic caps, that you find in the user manual bag, in the holes.

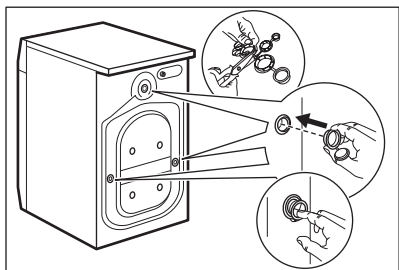

- i** We recommend that you keep the packaging and the transit bolts for any movement of the appliance.

4.2 Positioning and levelling

1. Install the appliance on a flat hard floor.

- i** Make sure that the appliance does not touch the wall or other units.

2. Loosen or tighten the feet to adjust the level.



WARNING!

Do not put cardboard, wood or equivalent materials below the appliance feet to adjust the level.

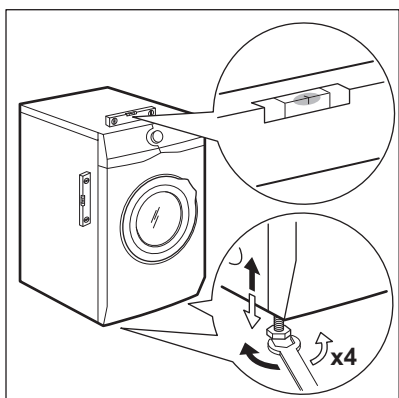

The appliance must be level and stable.

- i** A correct adjustment of the appliance level prevents the vibration, noise and the movement of the appliance when in operation.

- i** When the machine is installed on a plinth or if a washer dryer is stacked on the washing machine, use the accessories described in chapter 'Accessories'. Read carefully the instructions supplied with the appliance and with the accessory.

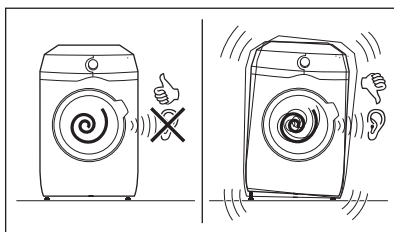

4.3 The inlet hose

1. Connect the water inlet hose to the cold water tap with 3/4" BSP thread.

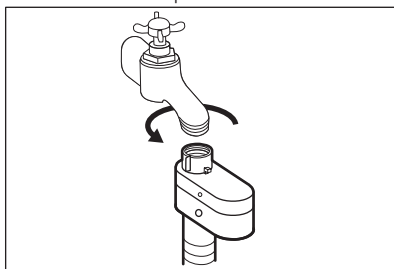

- i** Use the hose supplied with the appliance.



CAUTION!

Make sure that there are no leaks from the couplings.

2. Connect the other end of the inlet hose to the back of the appliance. The hose can be turned in any direction.
3. Position it toward left or right depending on the position of the water tap.

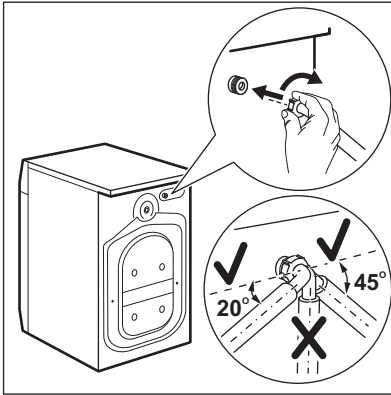

- i** Make sure that the inlet hose is not in vertical position.
4. If necessary, loose the ring nut to set it in the correct position. Simply loosen the fitting, rotate the hose and retighten the fitting, making sure there are no water leaks.

- i** Do not use an extension hose if the inlet hose is too short. Contact the service centre for purchasing a new, longer hose specially designed for this type of use.

4.4 Water-stop device

The inlet hose has a water stop device. This device prevents water leaks in the hose because of its natural ageing.

The red sector in the window «A» shows this fault.

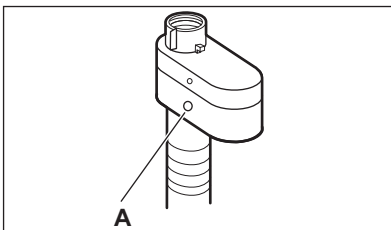

If this occurs, close the water tap and contact the authorized service centre to replace the hose.

4.5 Water drainage

The drain hose should be positioned at a height of not less than 60 cm and not more than 100 cm from the floor.

- i** You can extend the drain hose to maximum 400 cm. Contact the authorized service centre for the other drain hose and the extension.

It is possible to connect the drain hose in different ways:

1. Make a U shape with the drain hose and put it around the plastic hose guide.

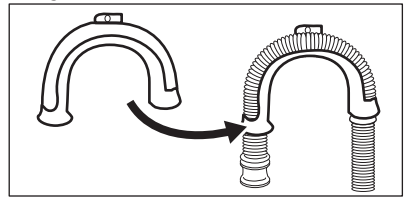

2. **On the edge of a sink** - Fasten the guide to the water tap or to the wall.

- i** Make sure that the plastic guide cannot move when the appliance drains.

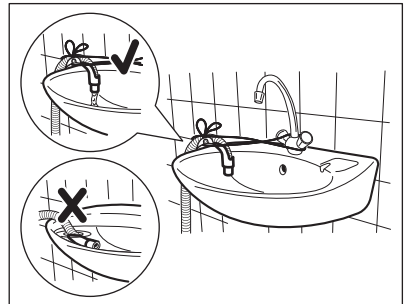

- i** Make sure that the drain hose end is not immersed in the water. There may be a return of dirty water into the appliance.

3. **To a stand pipe with vent-hole** - Insert the drain hose directly into a drain pipe. Refer to the illustration.

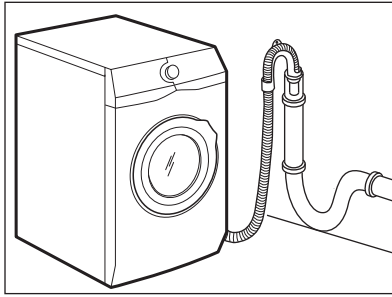

- i** The end of the drain hose must always be ventilated, i.e. the inner diameter of the drain pipe (min. 38 mm - min. 1.5") must be larger than the external diameter of the drain hose.

4. If the end of the drain hose looks like this (see the picture), you can push it directly into the stand pipe.

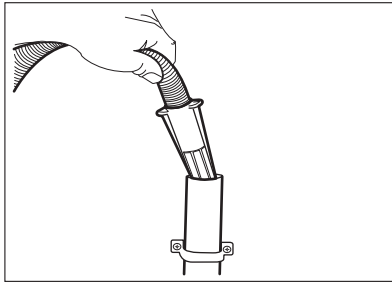

5. **Without the plastic hose guide, to a sink spigot** - Remove the plastic membrane from the sink trap spigot.
6. Connect the drain hose to the spigot and tighten it with a clamp.

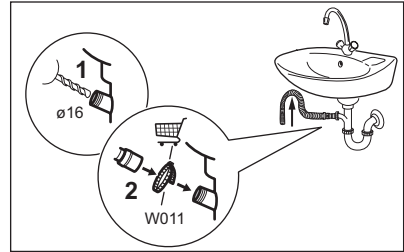

7. Position the hose **directly to a built-in drain pipe in the room wall** and tighten it with a clamp.

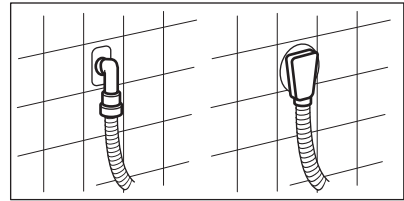

5. PRODUCT DESCRIPTION

5.1 Special features

Your new washing machine meets all modern requirements for an effective treatment of laundry with low water, energy and detergent consumption and proper care of fabric.

- The **interactive touch screen display** makes the setting and the use of the appliance more immediate and agreeable.
- The **SoftWater Technology** acts as **water softener** and removes harsh minerals from the inlet water and supplies soft water for the washing. Wash after wash, fabric stiffness, shrinkage and colour fading are prevented.
- The **Oko-Mix technology** has been designed to protect the fabric fibres thanks to different pre-mixing phases that dissolves first the detergent and then fabric softener in the water before they are distributed in the laundry. So every fibre is reached and cared for.
- Thanks to the **Weight Sensors** the appliance can detect the weight of your load and advise on how much detergent you need to achieve the best results without waste.
- The **ProSense technology** adjusts automatically the programme duration to the laundry in the drum to achieve perfect washing results in the minimum possible time.

- The steam has a quick and easy way to refresh the clothes. The gentle steam programmes remove odours and reduce creases in dry fabrics so they need little ironing. The **Plus Steam option**, finishes every cycle with gentle steam that relaxes the fibres and reduces fabric creasing. Ironing will be easier!
- The **Stains option** pre-treats stubborn stains optimizing the effectiveness of the stain remover.
- Thanks to the **Soft Plus option**, the fabric softener is uniformly spread out in the laundry and deeply penetrates the fabric fibres favouring a perfect softness.

5.2 Appliance overview

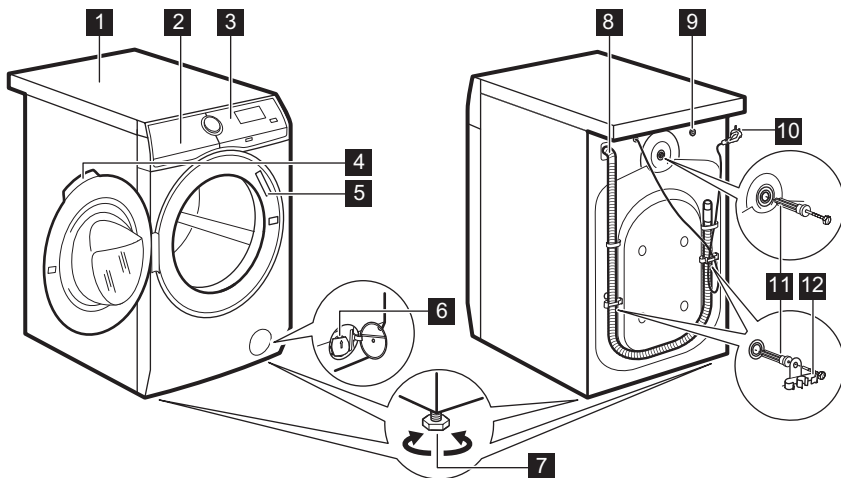

- 1 Worktop
- 2 Detergent dispenser and salt compartment
- 3 Control panel
- 4 Door handle
- 5 Rating plate
- 6 Drain pump filter
- 7 Feet for levelling the appliance
- 8 Drain hose
- 9 Inlet hose connection
- 10 Mains cable
- 11 Transit bolts
- 12 Hose support

5.3 Detergent dispenser and salt compartment



Always follow the instructions that you find on the packaging of the detergent products. Anyway, we recommend not to exceed the maximum indicated level in each compartment (**MAX**).

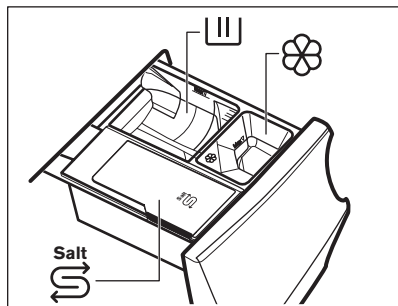

III Compartment for washing phase: powder detergent, stain remover.

i When using liquid detergent, make sure that the special container for liquid detergent is inserted. Refer to 'Filling the detergent and additives' in 'Daily Use' chapter.

Flower icon Compartment for liquid additives (fabric conditioner, starch).
Salt icon Compartment for salt.

i Read carefully 'The Water Softener technology (Soft Water)'.

MAX Maximum level for detergent/additives quantity.

i When selecting a prewash phase, put the detergent/additive in a dosing ball inside the drum.

i After a washing cycle, if necessary, remove any detergent residue from the detergent dispenser.

6. THE WATER SOFTENER (SOFTWATER TECHNOLOGY)

6.1 Introduction

The water contains harsh minerals. The higher the content of these minerals the harder the water is.

Hard water can reduce the effectiveness of the detergent, reduce the softness of fabrics and contribute towards shrinkage and colour fading.

This appliance is equipped with a water softener able to provide the right degree of water softening to preserve the fabric integrity, colour brightness and ensuring good wash performances at low temperature.

The water softener should be adjusted according to the water hardness of your inlet water. A correct setting allows to achieve the best washing results and the maximum garments protection.

To set the water softener correctly, please refer to 'How to set the water hardness level'.

i The first time you turn the appliance on, the touch screen proposes different settings: one on this is water hardness level.

6.2 How to set the water hardness level

The appliance allows you to choose between 7 levels corresponding to 7 different ranges of water hardness.

Depending on the country, the water hardness is expressed in equivalent scales: e.g. French degrees (°f), German degrees (°d), English degrees (°e), mmol/l and ppm.

If necessary, please contact your local water authority to check the water hardness in your area.

Check in the "Water hardness levels" table which is the proper level.

To set the water hardness level:

1. Press the **On/Off** button for a few seconds to activate the appliance.
2. Wait until the programme screen appears and scroll up and down the list to find **Settings**.

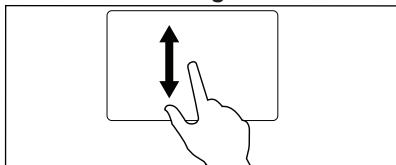



3. Tap on  to enter the setting list.

Spin	
Machine Clean	
Settings	
OKOPower	
ColourPro	

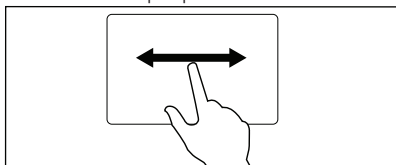
4. Scroll the list up and down to find **Water Hardness**.
5. Tap on the **Water Hardness** bar.
6. Scroll the level list right and left to chose the proper level.





<Programmes	Info	
 Buzzer	OFF	
 Water Hardness	6	
<5	6	7>

Water hardness levels

Levels	Levels as indicated on the tester ¹⁾	Water hardness range				
		°f (French degrees)	°d (German degrees)	°e (English degrees)	mmol/l	ppm
1	C01	≤5	≤3	≤4	≤0.5	≤50

7. Tap on the **Water Hardness** bar to exit and to confirm the chosen level.
8. Scroll up and down the setting list to find the **Water Softener** bar and tap on it to enter.

<Programmes	Info	
 Water Softener	Wash	
<	Wash	>

9. Scroll the bar right and left to chose:
 - **Wash**: the water softener acts during washing phase only. This setting satisfies most of the use condition.
 - **Wash & Rinse**: if the inlet water is particularly hard (**6** and **7** levels), we suggest to set the water softener also during rinsing phase to preserve the fabric softness.
-  This setting increases the salt consumption.
- **OFF**: to deactivate the water softener.

Levels	Levels as indicated on the tester ¹⁾	Water hardness range				
		°f (French degrees)	°d (German degrees)	°e (English degrees)	mmol/l	ppm
2	C02	6 - 13	4 - 7	5 - 9	0.6 - 1.3	60 - 130
3	C03	14 - 21	8 - 11	10 - 15	1.4 - 2.1	140 - 210
4 ²⁾	C04	22 - 29	12 - 16	16 - 20	2.2 - 2.9	220 - 290
5	C05	30 - 37	17 - 20	21 - 26	3.0 - 3.7	300 - 370
6	C06	38 - 45	21 - 25	27 - 32	3.8 - 4.5	380 - 450
7	C07	≥46	≥26	≥33	≥4.6	≥460

1) If supplied with the appliance.

2) Factory setting, able to satisfy most of the use conditions.

6.3 Pouring salt

The water softener function acts through special resins present in the appliance.

To regenerate the resins and make them ready to soften the water pour a special

salt in the compartment :

1. Open the detergent dispenser.

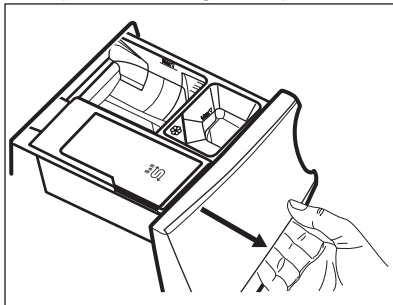

2. Open the compartment .

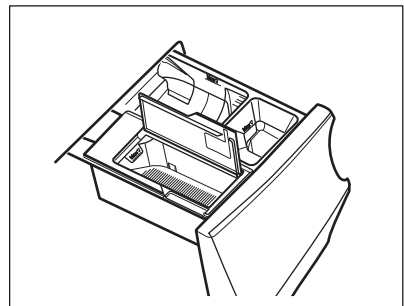

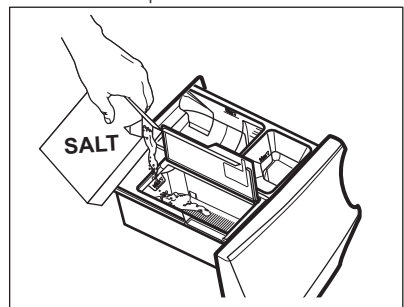

3. Pour the special salt.



4. Close the salt compartment and the detergent dispenser.

 Regularly check if there is enough salt.

The compartment  can contain about 600 gr of salt that are sufficient for about 20 - 300 washing cycles (or 4 - 70 weeks) depending on the set water hardness level and whether the water softener is activated during wash phase only. If the water softener is activated also during rinse phase, the salt refilling lasts 5 - 80 washing cycles (or 1 - 18 weeks) depending on the set water hardness level. Refer to 'How to set the water hardness level'.

The display shows the message **Top up salt** at the end of a cycle when compartment  needs to be refilled with salt, even if a little salt still remains.



WARNING!

Pour the salt in the compartment  only.



WARNING!

Do not put anything but salt in the compartment . If any other detergent/additive is poured inadvertently in this compartment, please refer to 'Eliminating detergent or other additives from salt compartment' in 'Troubleshooting' chapter.



Only use special salt for dishwasher and/or washing machine. Other types of salts are less efficient and over time could damage the water softener technology permanently. **Do not use fine salt!**



The appliance works normally even without salt, but without exploiting its full potential. If you use the appliance without salt for a long time, once the salt is finally refilled, the water softener function is completely restored after a few long washing cycles.

7. CONTROL PANEL

7.1 Control panel description

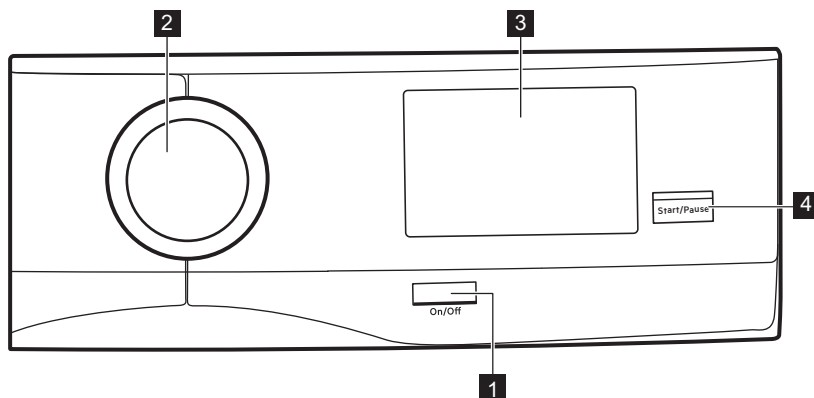

- 1 On/Off button (**On/Off**)
- 2 Programme dial
- 3 Touch screen

8. FIRST TIME START-UP

Each time you turn the appliance on, the Start-up Screen appears on the touch screen.

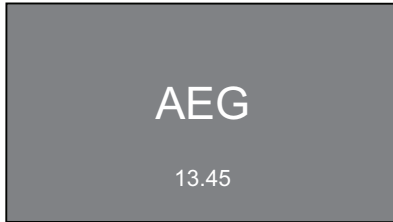

The first time you turn the appliance on, after the Start-up Screen you are guided through the initial setup procedure.

8.1 Language setup

1. Scroll the language list to find the desired language and hold the desired language pressed to set it.

1/4	Language
Svenska	SV
Deutsch	DE
English	EN
Italiano	IT
Francais	FR

2. The following screen pops up:
 - tap on **OK** to confirm the language:
 - tap on **Change** to change it.

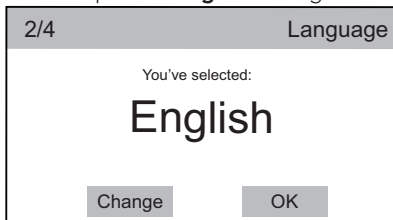

- 4 Start/Pause button (**Start/Pause**)

8.2 Time setup

1. Scroll the hour and minute bars to the right or to the left to set the current time.

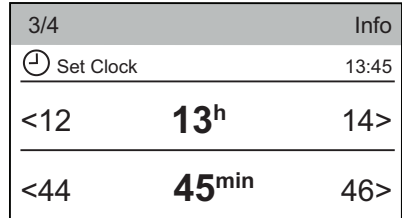

2. Tap on the **Set Clock** bar to set the time.

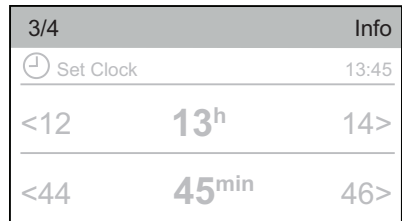

3. The following screen pops up:
 - tap on **OK** to confirm the set time.
 - tap on **Change** to change it.

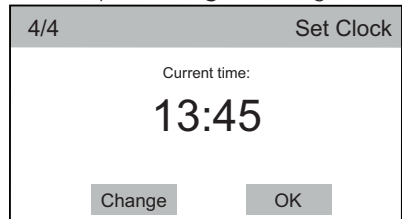

8.3 More settings

After you set the time, the **More settings** screen pops up.

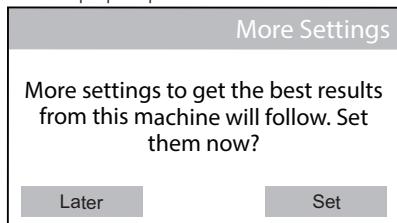

If you tap on **Later**, the programme list screen appears and you can set the desired programme.

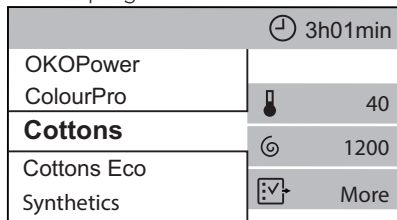

If you tap on **Set**, proceed with next settings.

8.4 Water Hardness

The display suggests to set the proper water hardness level to improve the washing results.

The following window pops up.

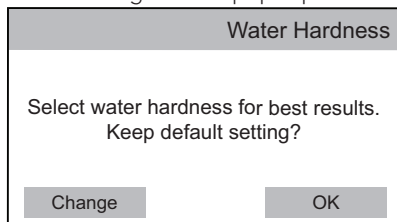

- Tap on **OK** to confirm the default setting.
1. Tap on **Change** to enter the **Water Hardness** submenu.

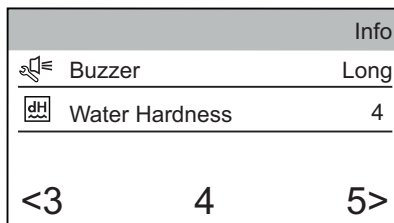

2. Scroll the level list right or left to set the desired water hardness level.

3. Tap on the **Water Hardness** bar. The following window pops up.

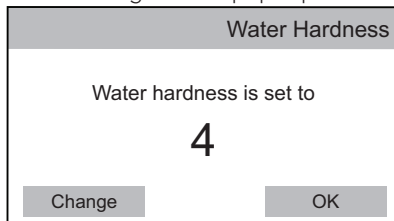

4. Tap on **OK** to confirm or on **Change** to change the level.

8.5 Detergent Dosing

You can set the average quantity of detergent suggested on the detergent packaging.

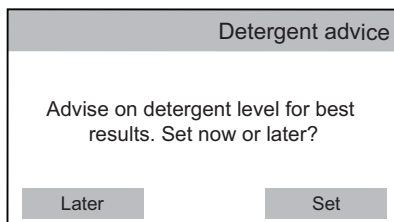

1. Tap on **Set**. The following window pops up.

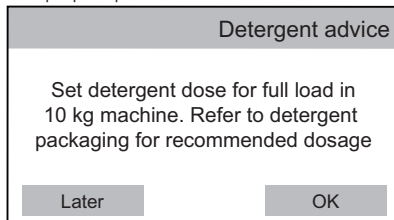

2. Tap on **OK** to enter the **Detergent Dosing** menu.
3. Tap on the **Detergent Type 1** or **Detergent Type 2** bar.

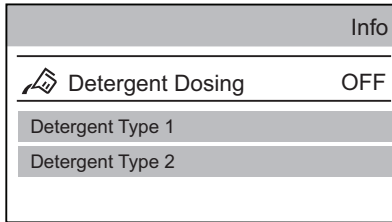

4. Scroll the submenu bar right or left to set the detergent dosage in ml that matches with the average dosage suggested on the detergent packaging.

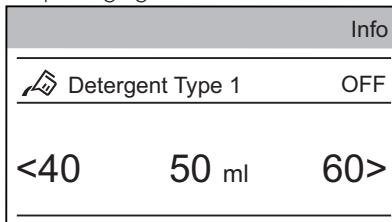

5. Tap on the **Detergent Type 1** bar. The following window pops up. Tap on **OK** to confirm your choice.

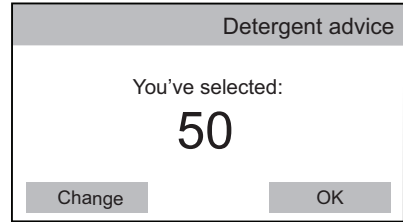

The setting is complete.

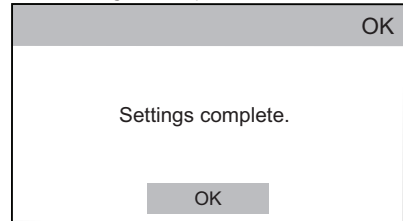

9. TOUCH SCREEN

Each time you turn the appliance on, the Start-up Screen appears on the touch screen.

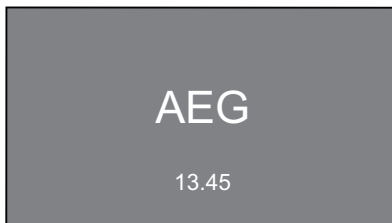

After a few seconds, the programme list screen appears proposing Cottons as default programme.

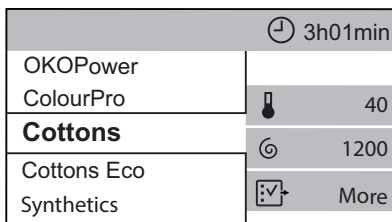

If you don't scroll the programme list up and down, in a few seconds the programme summary screen appears. To

return to the programme list screen just tap on the programme name (e.g. Cottons).

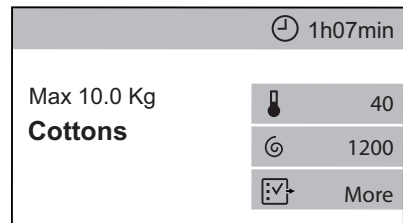

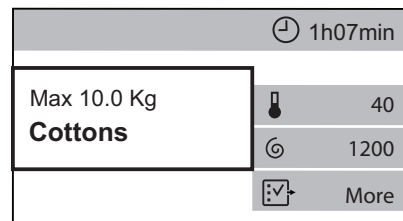

The summary screen shows:

- Programme maximum load, programme name.

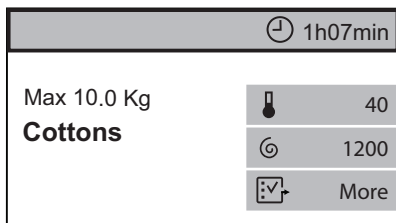

- Programme duration. If selected, this area can also show the delayed start or the **Time Save** symbol.



- The currently selected options. The shortcut  allows to enter the additional option menu.

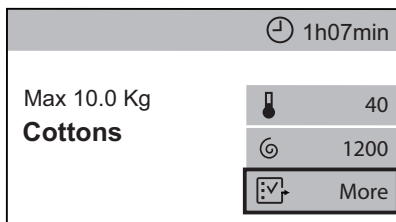

-  When a shortcut is visible on the summary screen, it is possible to enter an option/setting menu by just tapping on the relevant shortcut.

The different option/setting menus can be scrolled:

- up and down, or

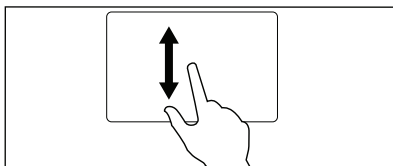

- right or left.

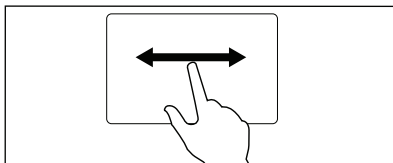



To set some options or settings it is sufficient to change the status from **OFF** to **ON** just tapping on the relevant bar.

-  Programmes, options and settings can also be set by turning the programme dial and in horizontal submenus the desired choice can be set just tapping on the arrows < or >.

10. BEFORE FIRST USE

-  During installation or before first use you may observe some water in the appliance. This is a residual water left in the appliance after a full functional test in the factory to ensure the appliance is delivered to customers in perfect working order and is no cause for concern.

1. Make sure that all transit bolts have been removed from the appliance.
2. Make sure that the electrical power is available and the water tap is open.

3. Make sure that there is salt in the compartment marked by  and set the proper water hardness level. Refer to "How to set the water hardness level".
4. Pour 2 litres of water into the detergent compartment marked by .

This action activates the drain system.

5. Set and start a programme for cotton at the highest temperature without any detergent and laundry in the drum.

11. PROGRAMMES

11.1 Programme Chart









All washing programmes benefit from the softened water, if the water softener is active.

Washing programmes

Programme	Programme description
Washing programmes	
OKOPower	Cotton and fast-coloured synthetic items. Complete washing programme that, in only 59 minutes, washes the daily soiled laundry intensively and ensures a good washing performance in a short time.
ColourPro	Coloured cottons and synthetics. Low-temperature cycle for a greater colour protection keeping good cleaning results thanks to softened water. To get the best care of your fabrics, we recommend not to fill the drum completely.
Cottons	White cotton and coloured cotton. Normal, heavy and light soil.
Cottons Eco	White cotton and coloured cotton. Normal, heavy and light soil.
Synthetics	Synthetic items or mixed fabric items. Normal soil.
Delicates	Delicate fabrics such as acrylics, viscose and mixed fabrics requiring gentler washing. Normal soil.

Programme	Programme description
Wool/Silk	<p>Machine washable wool, hand washable wool and other fabrics with «hand washing» care symbol¹⁾. Woolmark Apparel Care - Green</p>  <p>The wool wash cycle of this machine has been approved by The Woolmark Company for the washing of wool garments labelled as «hand wash» provided that the garments are washed according to the instructions issued by the manufacturer of this washing machine. Follow the garment care label for drying and other laundry instructions. M1361 In UK, Eire, Hong Kong and India the Woolmark symbol is a certification trademark.</p>
Steam programme	
Steam	<p>Steam programme for cotton and synthetic items. Steam can be used for dried²⁾, washed or worn once laundry. This programme reduce creases and odours³⁾ and relaxes the fibres. When the programme is completed, quickly remove the laundry from the drum. After a steam programme, ironing becomes effortless. Do not use any detergent. If necessary, remove stains by washing or using localized stain removal. Steam programmes do not perform any hygienic cycle. Do not set a Steam programme with these types of items:</p> <ul style="list-style-type: none"> • Items that are not suitable for tumble drying. • All items with plastic, metal, wooden parts or alike.
Washing programmes	
20min 3kg	Cotton and synthetic items lightly soiled or once worn.

Programme	Programme description
Outdoor	<p> Do not use fabric softener and make sure that there is no softener residue in the detergent dispenser.</p> <p>Outdoor clothing, technical, sport fabrics, waterproof and breathable jackets, shell jackets with a removable fleece or inner insulation. The recommended laundry load is 2.5 kg. This programme can also be used as water-repellent restoring cycle, specifically tailored for treating clothes with a hydrophobic coating. To perform the water-repellent restoring cycle, proceed as follows:</p> <ul style="list-style-type: none"> • Pour the washing detergent in the compartment . • Pour a special water-repellent restorer for fabric in the drawer compartment for fabric softener . • Reduce the laundry load to 1 kg. <p> To further improve the water-repellent restoring action, dry the laundry in a tumble dryer by setting the Outdoor drying programme (if available and if the garment care label permits tumble drying).</p>
Jeans	<p>Denim clothing and jersey items. Normal soil. This programme performs a gentle rinsing phase, designed for denim, that reduces fading and does not cause washing powder residues on the fibres.</p>
Anti-Allergy	<p>White cotton items. This programme removes micro-organisms thanks to a washing phase with the temperature maintained above 60°C for several minutes. This helps remove germs, bacteria, micro-organism and particles. An additional rinsing phase ensures a proper removal of detergent residues and pollens/allergenic items. In this way the wash is more effective.</p>
Rinse	<p>All fabrics, except woollens and very delicate fabrics. Programme for rinsing and spinning the laundry. The default spin speed is the one used for cotton programmes. Reduce the spin speed accordingly to the type of laundry. If necessary, set the Extra Rinse option to add rinses. With a low spin speed the appliance performs delicate rinses and a short spin.</p>
Drain	<p>All fabrics, except woollens and very delicate fabrics. Programme for draining the water left in the drum.</p>
Spin	<p>All fabrics, except woollens and very delicate fabrics. Programme for spinning the laundry and draining the water left in the drum. The default spin speed is the one used for cotton programmes. Reduce the spin speed accordingly to the type of laundry.</p>

Programme	Programme description
Machine Clean	<p>Maintenance cycle with hot water to clean and freshen the drum and to remove residue that may cause odour. For the best result use this cycle once a month. Before running this cycle, remove all items from the drum. Pour a cup of chlorine bleach or a washing machine cleaner in the washing phase compartment. DO NOT use both together.</p> <p> After the drum cleaning, run a further rinse cycle with empty drum and no detergent to remove any residue of bleach.</p> <p> Run this programme especially when the message Cleaning cycle recommended pops up. If the cleaning programme is postponed, the message keeps on popping up during next uses until it is run.</p>

1) During this cycle the drum rotates slowly to ensure a gentle wash. It can seem that the drum doesn't rotate or doesn't rotate properly, but this is normal for this programme.

2) If you set a Steam programme with dried laundry, at the end of the cycle the laundry can be humid. Line dry the items for about 10 minutes.

3) Steam programme doesn't remove particularly intense odour.

Programme temperature, maximum spin speed and maximum load

Programme	Default temperature Temperature range	Maximum spin speed Spin speed range	Maximum load
OKOPower	30 °C 60 °C - 30 °C	1600 rpm 1600 rpm - 400 rpm	5 kg
ColourPro	30 °C 30 °C - Cold	1200 rpm 1200 rpm - 400 rpm	10 kg
Cottons	40 °C 95 °C - Cold	1600 rpm 1600 rpm - 400 rpm	10 kg
Cottons Eco ¹⁾	40 °C 60 °C - 40 °C	1600 rpm 1600 rpm - 400 rpm	10 kg
Synthetics	40 °C 60 °C - Cold	1200 rpm 1200 rpm - 400 rpm	4 kg
Delicates	40 °C 40 °C - Cold	1200 rpm 1200 rpm - 400 rpm	4 kg
Wool/Silk	40 °C 40 °C - Cold	1200 rpm 1200 rpm - 400 rpm	2 kg
Steam	-	-	1.5 kg
20min 3kg	30 °C 40 °C - 30 °C	1200 rpm 1200 rpm - 400 rpm	3 kg

	Time Save ¹⁾	Spin Speed	Rinse & Hold	Extra Silent	Eco ²⁾	Stains ³⁾	Prewash	Soak	Extra Rinse	Plus Steam ³⁾	Soft Plus	Anti-crease	Steam Level
Delicates	■	■	■	■	■	■	■		■		■	■	
Wool/Silk		■	■										
Steam													■
20min 3kg		■											■
Outdoor		■	■						■			■	
Jeans	■	■	■		■	■	■		■	■	■	■	
Anti-Allergy		■	■			■	■		■	■	■	■	
Rinse		■	■						■			■	
Drain													
Spin		■											
Machine Clean		■											

¹⁾ If you set the shortest duration, we recommend that you decrease the load size. It is possible to fully load the appliance, however the washing results can be less satisfactory.

²⁾ This option is not available with a temperature lower than 30 °C.

³⁾ This option is not available with temperature lower than 40 °C.

12. OPTIONS

12.1 Introduction

i When you enter the menu  **More**, the display will show only the options available for the programme set.

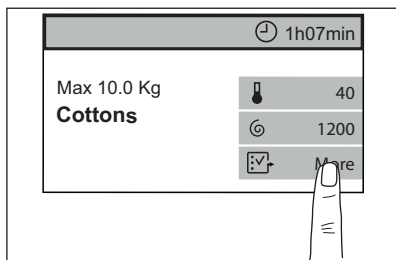

i When an option shortcut is on the programme summary screen, just tap on it to enter the relevant option submenu directly.

To turn an option on/off or to enter the option submenu, tap on the option bar.

To exit the option submenu, tap on the option bar again.

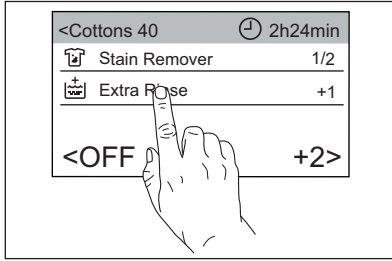

To return to the programme summary screen, tap on the programme bar.

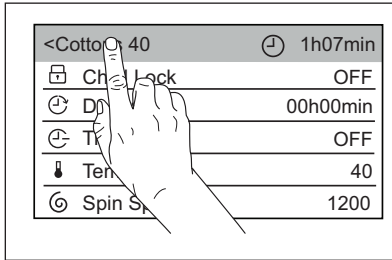

12.2 Child Lock

With this option you can prevent the children from accidentally operating the appliance.

To **activate** this option:

- Tap on the **Child Lock** bar, the appliance goes back to programme summary screen automatically and the shortcut  **comes on**.



You can activate this option:

- After you have pressed the Start/Pause button: Start/Pause button and the touch screen are deactivated. It is possible to turn the appliance off by means of the On/Off button.
- Before pressing the Start/Pause button: the appliance cannot start.

 The appliance keeps the selection of this option after you switch it off.

To **deactivate** this option:



- Keep the shortcut  pressed for 3 seconds until it **goes off**.

 If the shortcut  is on, you can **activate** this option by tapping on the shortcut  without entering the **More** menu. Refer to "Shortcuts" in chapter "Settings".

12.3 Delay Start

With this option you can delay the start of a programme to a more convenient time.

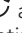
1. Tap on the **Delay Start** bar to enter the submenu.
2. Scroll left or right the hour and/minute bars to set the desired delay start.



When you return to programme summary screen, the indicator  and the set delay time appear alternating with the indicator  and the programme duration.

After touching the Start/Pause button, the appliance begins the countdown and the door is locked.

12.4 Time Save

With this option you can decrease the programme duration (**OFF**= normal programme duration).

1. Tap on the **Time Save** bar to enter the submenu.
2. Scroll the submenu bar right to set:
 - **Quick** option (**Mid**): if your laundry is normally or lightly soiled, it may be advisable to shorten the washing programme.
 - **Extra Quick** option (**Max**): in case of smaller load.

When you return to programme summary screen, the indicator  **Quick** or  **Extra Quick** appears replacing the indicator  and the programme duration is updated.

12.5 Temperature

When you select a washing programme, the appliance automatically proposes a default temperature.

1. Tap on the **Temperature** bar to enter the submenu.
2. Scroll the submenu bar to set the desired temperature. **Cold**= Cold wash.

When you return to programme summary screen, the set temperature will be shown.

12.6 Spin Speed

When you set a programme, the appliance automatically selects the maximum spin speed.

1. Tap on the **Spin Speed** bar to enter the submenu.
2. Scroll the submenu bar right or left to:

- **Decrease the spin speed;**

 The display shows only the spin speeds available for the set programme.

- or **activate the Rinse & Hold option ;**

When you return to programme summary screen, the indicator  shows up.

The water of the last rinse is not drained out to prevent the fabrics from creasing. The washing programme ends with water in the drum and the final spin phase is not performed.

The door stays locked.

The drum turns regularly to reduce creasing. You must drain the water to unlock the door.

Touch the **Start/Pause** button: the appliance performs the spinning phase and drains the water.

- or **activate the Extra Silent option.**

When you return to programme summary screen, the indicator  will be on.

All spinning phases (intermediate spin and final spin) are suppressed and the programme ends with water in the drum. This helps to reduce creasing. As the programme is very quiet, it is suitable for use at night time when cheaper electricity tariffs are available. In some programmes the rinses are performed with more water. The door stays locked.

The drum turns regularly to reduce creasing. You must drain the water to unlock the door.

Touch the **Start/Pause** button: the appliance performs the draining phase only.

 The appliance empties the water out automatically after approximately 18 hours.

12.7 Eco

Set this option for slightly or normally soiled items washed at 30°C or higher temperatures.

Tap on the Eco bar to turn the option on.

The appliance decreases the washing temperature and extends the washing time to obtain a good washing efficiency by saving energy.

When you return to programme summary screen, the shortcut  will be on.

12.8 Stains

1. Tap on the **Stains** bar to enter the submenu.
2. Tap on the bar of the option you want to set:

- **Stains**

Select this option to pre-treat heavily soiled or stained laundry using stain remover.

Pour the stain remover into compartment . The stain remover is pre-mixed and heated with detergent in order to improve its effectiveness.

 This option can increase the programme duration.

 This option is not available with a temperature lower than 40 °C.

- **Prewash**

Use this option to add a prewash phase at 30 °C before the washing phase.

This option is recommended for heavily soiled laundry, especially if

containing sand, dust, mud and other solid particles.

 Put the detergent for prewash in a dosing ball inside the drum.

 This option can increase the programme duration.

• Soak

Use this function for heavy soiled garments. The appliance soaks the laundry at 30°C for about half an hour before washing.

When you return to programme summary screen, the shortcut  will be on.

12.9 Extra Rinse



With this option you can add up to 3 rinses accordingly to the selected washing programmes.

Useful for people allergic to detergents and with sensitive skin.

1. Tap on the **Extra Rinse** bar to enter the option submenu.
2. Scroll the bar right to add from 1, 2 or 3 additional rinses (**OFF**= no additional rinse).

When you return to programme summary screen, the shortcut  will be on. The dots indicate the number of additional rinses selected.

 This option increases the programme duration.

 If the Extra Rinse is set as a default option and you select a compatible washing programme, the touch screen will show . In this case, by setting the Extra Rinse option, it is possible to add just one rinse .

12.10 Plus Steam

This option adds a steam phase followed by a short anti-crease phase at the end of the washing programme.

The steam phase reduces fabric creasing and facilitates the fabric ironing.

Tap on the **Plus Steam** bar to activate the option (**ON** status).

 This option can increase the programme duration.

 A small laundry load helps to reach better results.

When you return to programme summary screen, the shortcut  will be on.

12.11 Soft Plus

Set the Soft Plus option to optimise the fabric softener distribution and improve the fabric softness.

It is suggested when using the fabric softener and especially when the drum is full and the laundry is very soiled.

 This option increases slightly the programme duration.

Tap on the Soft Plus bar to activate the option (**ON** status).

When you return to programme summary screen, the shortcut  will be on.

12.12 Anti-crease

When this option is set, at the end of the cycle the drum performs smooth movements for about 30 minutes to favour the garments softness.

Tap on the **Anti-crease** bar to activate the option (**ON** status).

When you return to programme summary screen, the shortcut  will be on.

12.13 Steam Level

With this option you can change the steam level depending on the laundry size.

1. Tap on the **Steam Level** bar to enter the submenu.
2. Scroll the list right or left to set one of the following levels:
 - **Minimum**
 - **Medium**

- **Maximum**

i This is available with the **Steam** programme only.

12.14 ☆ Memory

With this option it is possible to save the two most used washing programmes.

To **save** your favourite programmes:

1. First set the washing programme and the desired options.
2. Tap on the **Memory** bar to enter the submenu.
3. Tap on the **Memory 1** or **Memory 2** to save the set programme. The status will change from **Empty** to **In Use**.

When you return to programme list screen, the **M1** or **M2** will be on next to the programme name when you set it.

i Afterwards, each time you turn the appliance on, the **M1** and/or **M2** programmes appear among the first five programmes automatically proposed by the appliance and you can set them in the programme list screen directly.

		🕒 1h07min
Settings		
Cottons		🔥 40
Cottons	M1	🌀 1200
Cottons Eco		📄 More
Synthetics		

To **change** a saved programme:

1. First set the washing programme and the desired options.
2. Tap on the **Memory** bar to enter the submenu.
3. Tap on the **Memory 1** or **Memory 2** bar with **In Use** status. A message pops up asking if you want to empty or replace the saved programme.
4. Tap on **Replace**.

To **cancel** a saved programme:

1. Tap on the **Memory** bar to enter the submenu.
2. Tap on the **Memory 1** or **Memory 2** bar. A message pops up asking if you want to empty or replace the saved programme.
3. Tap on **Empty**. **M1** or **M2** will disappear in the programme list screen.

13. DAILY USE

! **WARNING!**
Refer to Safety chapters.

13.1 Using weight sensors

i For a correct use of the weight sensor, the drum must be empty when activating the appliance. Set the programme **BEFORE** you put the laundry in the drum.

13.2 Before activating the appliance

1. Make sure that the mains plug is connected to the mains socket.
2. Make sure that the water tap is open.

13.3 Activating the appliance and setting a programme

Press the **On/Off** button to turn the appliance on.

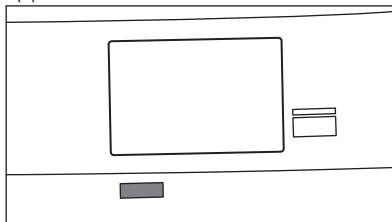

A short tune sounds (if activated). The appliance proposes **Cottons** as default programme. The led of **Start/Pause** button flashes.

13.4 Stand-by function

The Stand-by function automatically deactivates the appliance to decrease the energy consumption when:

- You do not use the appliance for 5 minutes before pressing the **Start/Pause** button and turning the appliance on.
Press the **On/Off** button to activate the appliance again.
- After 5 minutes from the end of the washing programme.
Press the **On/Off** button to activate the appliance again.
The display shows the end of the last set programme.
Turn the programme dial to set a new cycle.

i If you set a programme or an option that ends with water in the drum, the Stand-by function **doesn't deactivate** the appliance to remind you to drain the water.

13.5 Setting a programme

- Turn the programme dial to set the desired programme.

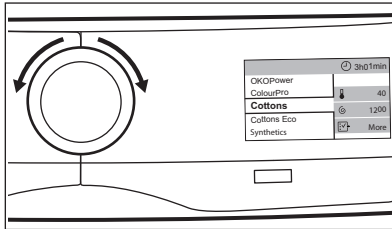

Or just tap on the programme name in the programme summary window to return to the programme list window and scroll the programme list up or down to set the desired programme.

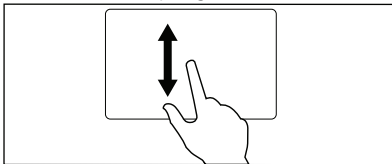

- After a few seconds the display shows programme summary screen indicating the maximum load, the default temperature, the maximum

spin speed and the programme duration.

- You can tap on the **Temperature** bar to change the water temperature.
- You can tap on the **Spin Speed** bar to change the spin speed or to set **Rinse & Hold** or **Extra Silent** option.
- You can tap on **More** to enter the menu of the additional available options and set one or more of them.

Afterwards, the shortcuts of the set options show up on the programme summary screen.

i The message **This setting is not available** pops up in case of wrong selection.

13.6 Loading the laundry

- Open the appliance door.
The weight sensor window pops up.

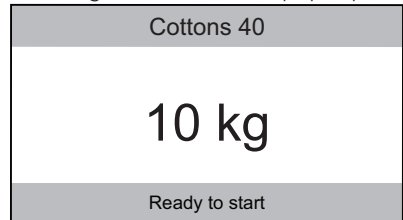

- Shake the garments before you put them in the drum.
- Put the laundry in the drum, one item at time.

On the display the weight of the laundry is updated by steps of 0.5 kg and the programme duration is updated accordingly when you return to the programme summary screen.

i If you put in the drum more laundry than the maximum load, the display tells that the suggested load has been exceeded.

You can wash your laundry anyway, but the water and energy consumption increase.

To have the best consumption and washing performance remove the excess items.

The overload indication is shown only in programmes with a maximum load lower than the appliance maximum load.

4. Close the door. Make sure that no laundry stays between the seal and the door. There is a risk of water leakage or damage to the laundry.

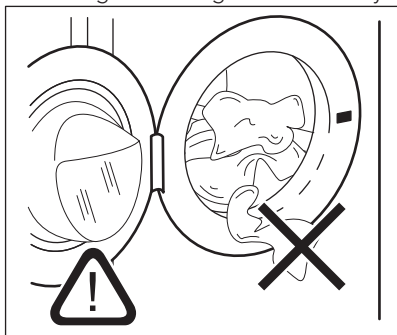

5. If you have already set **Detergent Type 1** or **Detergent Type 2** with average suggested dosage for the type of detergent you are using, the appliance recommends the detergent quantity to pour.

Cottons 40
Detergent advice:
60ml / 50ml Type 1 / Type 2
Ready to start

Refer to the "Detergent Dosing" section in the chapter "Settings".

i If you change the washing programme after closing the door, the display may tell you that the laundry is now exceeding the maximum recommended load for the new programme: open the door and remove a few garments.

13.7 Filling the detergent and additives

i We recommend that you do not exceed the maximum indicated level (**MAX**).

i Please read "Detergents type and quantity of detergent" in "Hints and tips" chapter.

1. Open the detergent dispenser.

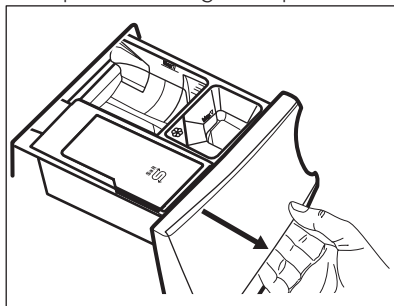

2. Put the powder detergent in the compartment **II**. If using liquid detergent, refer to 'Filling the liquid detergent'.

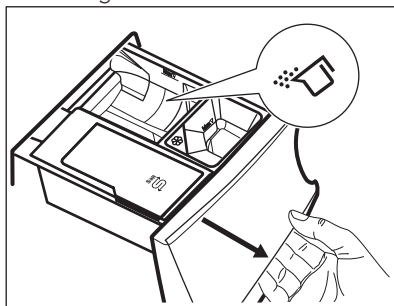

3. If desired, pour the fabric softener in the compartment **☼**.

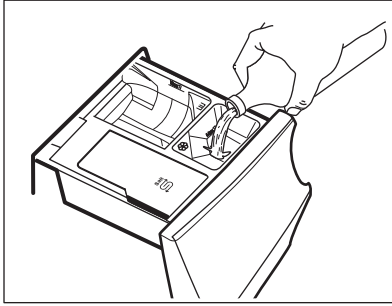

4. Close the detergent dispenser.

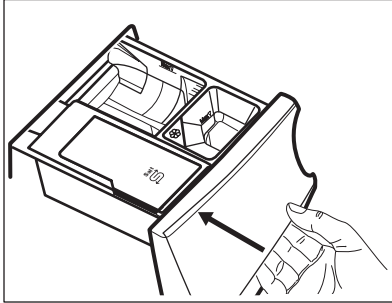

Filling the liquid detergent

1. Insert the proper container for liquid detergent.

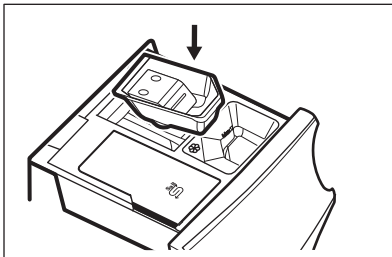

2. Pour the liquid detergent in the compartment .

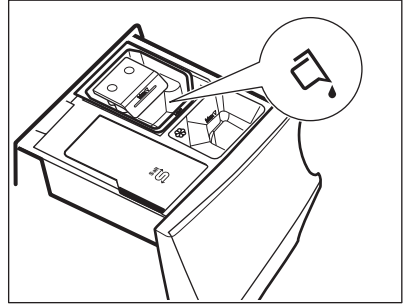

3. Close the detergent dispenser.





13.8 Starting a programme

1. Touch the **Start/Pause** button to start the programme.

The related led stops flashing and stays on.

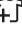
The door is locked.

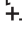
The window describing the running programme pops up, showing:

- The programme name.
- The remaining time to programme end.
- The progress bar.
- The ProSense phase first and then the running programme phase.
- The indicator . When it is on, it is still possible to stop the cycle and add clothes.
- The door locked indicator  when the indicator  goes off.
- The estimated cycle end time.
- The shortcut .

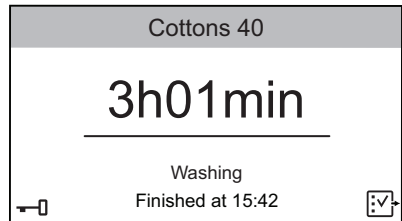

The drain pump can operate shortly before the appliance fills water.

2. If necessary, tap on  to enter the option list and activate the **Child Lock** option. Refer to "Child Lock" section in the "Options" chapter.

The shortcut  shows up. Keep  pressed for about three seconds to deactivate the **Child Lock**.

Starting a programme with delay start

1. Touch the **Start/Pause** button to start the programme.

The related led stops flashing and stays on.

The door is locked.

The appliance starts the countdown and the door is locked.

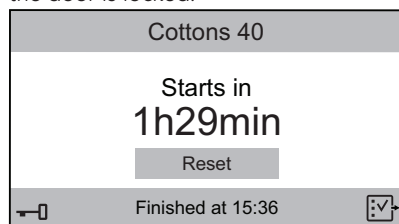

2. Tap on **Reset** to cancel the delay start and then touch the **Start/Pause** button or wait until the countdown is completed.

The programme will start normally.

 The ProSense detection starts at the end of the countdown.

 During the cycle, the display will inform you about each running phase (e.g. washing, rinsing and so on).

13.9 The ProSense load detection

After touching the **Start/Pause** button:

1. The ProSense starts the laundry load detection to calculate the real programme duration. The display shows the message **Adjusting programme to current load**.

The appliance adjusts automatically the programme duration to the load to achieve perfect washing results in the minimum possible time. The programme duration could increase or decrease.

2. After about 20 minutes the display shows the new programme duration, the expected programme time and advise you about the running phase.

 The ProSense detection is carried out with complete washing programmes only.

13.10 Interrupting a programme and changing the options

When the programme is running, you can change only some options:

1. Touch the **Start/Pause** button . The related led start flashing.
2. Tap on  to change the options. In the option list only the available options will be active.
3. Touch the **Start/Pause** button again. The washing programme continues and the programme duration can change.

13.11 Cancelling a running programme



1. Press the **On/Off** button to cancel the programme and to deactivate the appliance.
2. Press the **On/Off** button again to activate the appliance.

Now, you can set a new washing programme.

 If the ProSense phase is already carried out and the water filling is already started, the new programme starts **without repeating the ProSense phase**. The water and the detergent are not drained out in order to avoid waste.

13.12 Opening the door

 If the temperature and level of the water in the drum are too high and/or the drum still rotates you cannot open the door.

-  If  is on: the water temperature and level are not high and it is still possible to open the door and add clothes.

While a programme or the delay start operates, the appliance door is locked.

1. Touch the **Start/Pause** button . In the display the related door lock indicator goes off.
2. Open the appliance door. If necessary, add or remove the items.
3. Close the door and touch the **Start/Pause** button.

The programme or the delay start continues.

13.13 End of the programme

When the programme has finished, the appliance stops automatically. The acoustic signals operate (if they are active).

The display tells that the cycle is finished and shows **0h00min**.

The **Start/Pause** button goes off.

The door unlocks and the indicator  goes off.

1. Press the **On/Off** button to deactivate the appliance. After five minutes after the end of the programme, the energy saving function automatically deactivates the appliance.

-  When you activate the appliance again, the display shows the end of the last selected programme. Turn the programme dial to set a new cycle.



2. Remove the laundry from the appliance.

3. Make sure that the drum is empty.
4. Keep the door and the detergent dispenser slightly ajar to prevent mildew and odours.
5. Close the water tap.

13.14 Draining water out after end of cycle

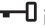
If you have chosen a programme or an option that does not empty out the water of the last rinse, the programme is completed, but:

- The display shows **0 min** and the **Start/Pause** button starts flashing.
- The drum still turns at regular intervals to prevent the creases in the laundry.
- The indicator  is still on and the door stays locked.
- You must drain the water to open the door:

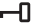
1. Touch the **Start/Pause** button:
 - If you have set , the appliance drains the water and spins.
 - If you have set  **dB**, the appliance only drains the water.
2. If necessary, change the spin speed proposed by the appliance: touch the **Start/Pause** button to pause the programme; tap on  and then on the **Spin Speed** bar.
3. When the programme is completed and the door locked indicator  goes off, you can open the door.
4. Press the **On/Off** button for a few seconds to deactivate the appliance.

-  In any case, the appliance empties the water out automatically after approximately 18 hours.

14. SETTINGS

14.1 Introduction

1. In the programme summary screen, just tap on the screen to return to the programme list screen.
2. Scroll the list up or down to find **Settings**.

Spin Machine Clean	
Settings	
OKOPower ColourPro	

3. Tap on the shortcut  to enter the setting menu.
4. Scroll the setting list up or down to find the setting you want to change.

14.2 ⌚ Set Clock

To change the time:

1. Tap on the **Set Clock** bar to enter the submenu.
2. Scroll the minute and the hour bars right or left to set the current time.

<Programmes	Info
 Set Clock	01h00min
< 24	01 ^h 02 >
< 59	00 ^{min} 01 >

3. Tap on the **Set Clock** bar to return to the machine setting list or tap on the **Programmes** bar to return to the programme summary screen.

14.3 🗣️ Set Language

To change the language:

1. Tap on the **Language** bar.
2. Scroll the language list up or down to find the desired language and hold it pressed.

Back	Language
Svenska	SV
Deutsch	DE
English	EN
Italiano	IT
Francais	FR

3. The screen returns to the setting list automatically. Tap on the **Programmes** bar to return to the programme summary screen.

14.4 ☀️ Display Brightness

You can regulate the display brightness through 5 brightness levels.

To change the display brightness:

1. Tap on the **Display Brightness** bar.
2. Scroll the brightness level bar right or left to find the desired level.

<Programmes	Info
 Display Brightness	4
< 3	4 5 >



3. Tap on the **Display Brightness** bar to return to the machine setting list or tap on the **Programmes** bar to return to the programme summary screen.

14.5 🔔 Cycle End Buzzer

A buzzer sounds at the end of a cycle.

To **deactivate** the buzzer or to **change** its duration:

1. Tap on the **Cycle End Buzzer** bar.
2. Scroll the bar right or left to set the desired set:
 - OFF
 - Short
 - Mid
 - Long
3. Tap on the **Cycle End Buzzer** bar and then to the **Programmes** bar to return to the programme summary screen.

If the Cycle End Buzzer is on, the screen shows the shortcut  (buzzer on) or  (buzzer off). Refer to "Shortcuts" section in this chapter.

14.6 🚰 Water Hardness





To set the proper water hardness level, read the "The Water Softener (SoftWater Technology)" chapter carefully.

To change the water hardness:

1. Tap on the **Water Hardness** bar.

2. Scroll right or left to set the proper water level.

<Programmes		Info
 Buzzer		OFF
 Water Hardness		6
<5 6 7>		



3. Tap on the **Water Hardness** bar to return to the machine setting list or tap on the **Programmes** bar to return to the programme summary screen.

14.7 Extra Rinse Default

With this option you can permanently have two additional rinses each time you switch the appliance on and if you set a compatible programme.

To **activate/deactivate** this option:

1. Tap on the **Extra Rinse Default** bar (ON status).
2. Tap on the **Programmes** bar to return to the programme summary screen.

If the **Extra Rinse Default** is active, the screen will show  and by setting the Extra Rinse option, it will be possible to add just one rinse .

If the **Extra Rinse Default** is activated, the screen will also show the shortcut . Refer to "Shortcuts" section in this chapter.

14.8 Soft Plus Default

Set the **Soft Plus Default** to optimise the fabric softener distribution and improve the fabric softness. The **Soft Plus** option remains permanently on.

It is suggested when using the fabric softener and especially when the drum is full and the laundry is very soiled.



This option increases slightly the programme duration.

To **activate/deactivate** this option:

1. Tap on the **Soft Plus Default** bar (ON status).

2. Tap on the **Programmes** bar to return to the programme summary screen.

If **Soft Plus Default** is active, the shortcut  will be on if you set a compatible programme.

14.9 Detergent Dosing

Through this setting you can save the average detergent dosage suggested in the detergent packaging, so the appliance will advise you about the necessary detergent dosage for your cycles.

It is possible to set two types of detergent: e.g., the value entered in **Detergent Type 1** could refer to powder detergent and the value entered in **Detergent Type 2** could refer to liquid detergent.

1. Tap on the Detergent Dosing.
2. Tap on the **Detergent Type 1** or **Detergent Type 2** bar.

		Info
 Detergent Dosing		OFF
Detergent Type 1		
Detergent Type 2		

3. Scroll the bar right or left to set the average detergent dosage in ml as suggested on the detergent packaging.

		Info
 Detergent Type 1		OFF
<40 50 ml 60>		

4. Tap on the **Detergent Dosing** bar to return to the machine setting list or tap on the **Programmes** bar to return to the programme summary screen.

14.10 Water Softener

-  Read the "The Water Softener (SoftWater Technology)" chapter carefully.

With this setting you can decide when the water softener function should operate:

1. Tap on the **Water Softener** bar.

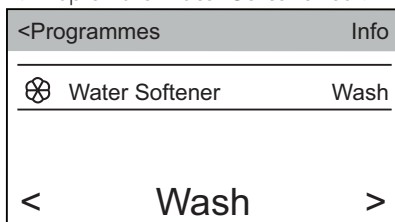

2. Scroll the submenu bar right or left to set:
 - **OFF**: the water softener function is deactivated.
 - **Wash**: the water softener function is active during washing phase only (factory setting).
 - **Wash & Rinse**: the water softener function is active during washing and rinsing phase.

-  This setting increases the salt consumption.

3. Tap on the **Water Softener** bar to return to the machine setting list or tap on the **Programmes** bar to return to the programme summary screen.

14.11 Service

This area is reserved for the Authorized Service.

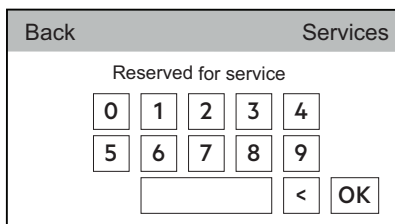

14.12 Shortcuts

This setting allows to bring the shortcuts shown in the next drawing visible on the summary screen.

To activate the shortcuts:

1. Tap on the **Shortcuts** bar to open the list of the available shortcuts.

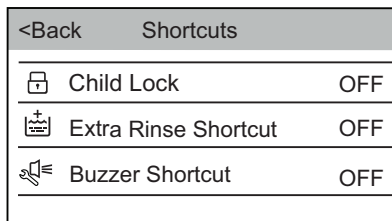

2. Tap on the bar of the desired shortcut/shortcuts by changing the status to **ON**.
3. Tap on **<Back** to return to machine setting list and on **Programmes** to return to summary screen.

The shortcut shows up on bottom.

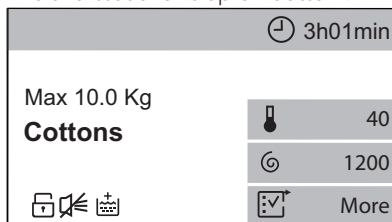

The shortcut  appears when the relevant option is set.

14.13 Machine Information

Here you can find a short description about all programmes, options and settings.

To find the desired description, e.g.:

1. Tap on the **Machine Information** bar.
2. Tap on **1. Programmes** bar.
3. Tap on **Cottons** bar and the relevant description will appear.

14.14 Factory Reset

Factory Reset restores the original factory settings.

To return to the factory settings:

1. Tap on the **Factory Reset** bar. The following window pops up.

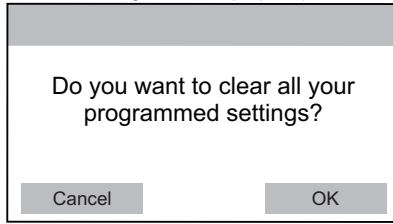

2. Tap on **OK** to return to factory settings or on **Cancel** to keep the current settings.

15. HINTS AND TIPS



WARNING!

Refer to Safety chapters.

15.1 The laundry load

- Divide the laundry into: white, coloured, synthetics, delicates and wool.
- Follow the washing instructions on the laundry care labels.
- Do not wash white and coloured items together.
- Some coloured items can discolour with the first wash. We recommend that you wash them separately for the first couple of times.
- Button up pillowcases, close zippers, hooks and poppers. Tie up belts.
- Empty pockets and unfold.
- Turn multilayered fabrics, wool and items with printed illustrations inside out.
- Pre-treat tough stains.
- Wash heavy soil stains with a special detergent.
- Be careful with curtains. Remove the hooks and put the curtains in a washing bag or pillowcase.
- Do not wash laundry without hems or with cuts.
- Use a washing bag to wash small and/or delicate items (e.g. underwired bras, belts, tights, etc.).
- A very small load can cause balance problems with the spin phase leading to excessive vibration. If this occurs:
 - a. interrupt the programme and open the door (refer to "Daily Use" chapter);

- b. manually redistribute the load so that the items are spaced evenly around the tub;
- c. press the Start/Pause button. The spin phase continues.

15.2 Stubborn stains

For some stains, water and detergent is not sufficient.

We recommend that you pre-treat these stains before you put the items in the appliance.

Special stain removers are available. Use the special stain remover that is applicable to the type of stain and fabric.

15.3 Detergents type and quantity of detergent

Low sudsing detergent is required for this washing machine to prevent oversudsing problems, unsatisfied washing result and harm to the appliance. Low sudsing detergents designed for front load washing machines are labelled "Front loading", "high efficiency", "HE" or "Matic".

Do not use wrong types of detergent, such as Top Loading, Handwash detergent or Soap-Based products in your front-load washing machine. This can result in excessive suds, longer cycle time, low spin speeds, poor rinsing and overloading of the motor and, in extreme cases, suds flowing out of the appliance with symptoms similar to water leak.

Quantity of detergent to be used

The choice of detergent and use of correct quantities not only affects your wash performance, but also helps to avoid waste and protect the environment.

Although biodegradable, detergents contain substances which in large quantities can upset the delicate balance of nature.

The choice and quantity of detergent will depend on:

- type of fabric (delicates, woollens, cottons, etc);
- the colour of clothes;
- size of the load;
- degree of soil;
- wash temperature; and
- hardness of the water used.

Water hardness is classified by so-called "degrees" of hardness.

Information on hardness of the water in your area can be obtained from the relevant water supply company, or from your local authority.

You may have to try using the detergent quantity as per manufactures' instructions then compare the wash

result to the list below and adjust the amount of detergent for your future washes accordingly.

Not enough washing powder causes:

- the wash load to turn grey,
- greasy clothes.

Too much washing powder causes:

- sudsing,
- reduced washing effect,
- inadequate rinsing.

Use less detergent if:

- you are washing a small load,
- the laundry is lightly soiled,
- large amounts of foam during washing.

15.4 Ecological hints

- Set a programme without the prewash phase to wash laundry with normal soil.
- Always start a washing programme with the maximum load of laundry allowed.
- If you pre-treat the stains, you can use a stain remover when you set a programme with a low temperature.
- To use the correct quantity of detergent, refer to the quantity suggested by the detergent producer.

16. CARE AND CLEANING



WARNING!

Refer to Safety chapters.

16.1 External cleaning

Clean the appliance with mild soap and warm water only. Fully dry all the surfaces.



CAUTION!

Do not use alcohol, solvents or chemical products.



CAUTION!

Do not clean the metal surfaces with chlorine-based detergent.

16.2 Descaling



If you use the salt regularly to activate the SoftWater Technology, the descaling procedure described in this paragraph is not necessary.



If the water hardness in your area is high or moderate, we recommend that you use a water descaling product for washing machines.

Regularly examine the drum to check for limescale.

The regular detergents already contain water softening agents, but we recommend to run a cycle with empty

drum and a descaling product occasionally.

- i** Always follow the instructions that you find on the packaging of the product.

16.3 Maintenance wash

The repeated and prolonged use of low temperature and short programmes can cause detergent deposits, fluff residues and bacterial growth inside the drum and the tub. This could generate bad odours and mildew.

To eliminate these deposits and hygienize the inner part of the appliance, run a maintenance wash after about 60 cycles, especially when the message **Cleaning cycle recommended** pops up on the display:

1. Remove all laundry from the drum.
2. Run the **Machine Clean** programme as described in the 'Programmes' chapter.

- i** If the cleaning programme is postponed, the message keeps on popping up during next uses until it is run.

16.4 Door seal

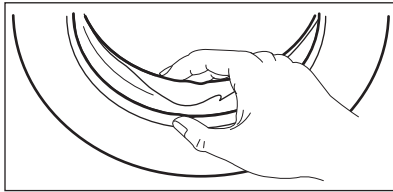

Regularly examine the seal and remove all objects from the inner part.

16.5 Cleaning the drum

Regularly examine the drum to prevent rust forming.

For a complete cleaning:

1. Clean the drum with special products for stainless steel.

- i** Always follow the instructions that you find on the packaging of the product.
2. Run a short cotton programme at high temperature with empty drum in order to rinse out any residues left .

16.6 Cleaning the detergent dispenser and the salt compartment

- i** Before cleaning, make sure that the all compartments are empty.

To prevent possible deposits of dried detergent, clotted fabric softener, formation of mould in the dispenser drawer and/or salt fouling in the salt compartment, once in a while carry out the following cleaning procedure:

1. Open the drawer. Press the catch as indicated in the picture and pull the drawer out.

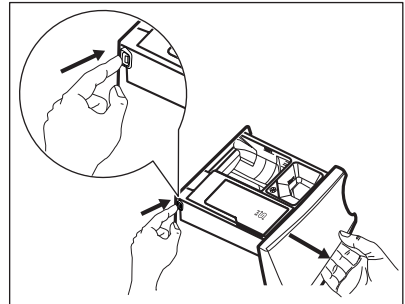

2. Remove the insert for the softener and, if inserted, the container for liquid detergent.

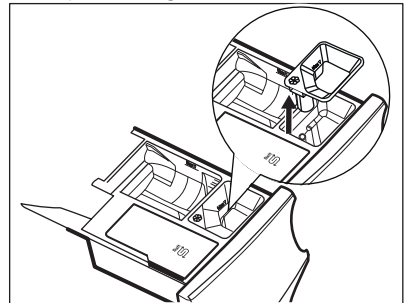

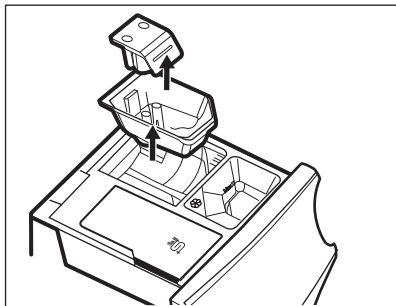

3. Wash the drawer and all inserts under running water.

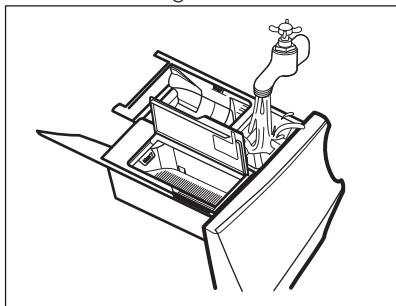

4. Make sure that all detergent residue is removed from the detergent conveyor. Use a cloth.

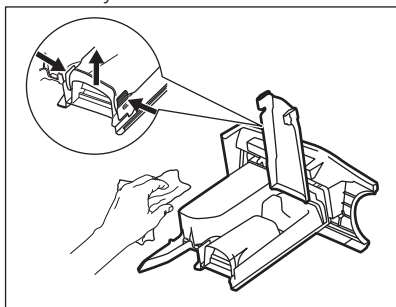

5. Make sure that all detergent residue is removed from the upper and lower part of the recess. Use a small brush to clean the recess.

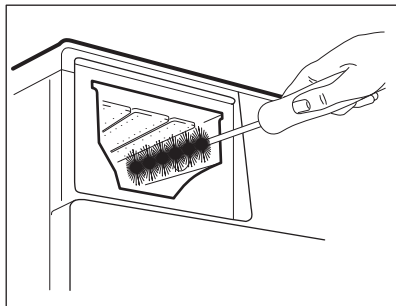

6. Insert the detergent drawer into the guide rails and close it. Run the rinsing programme without any clothes in the drum.

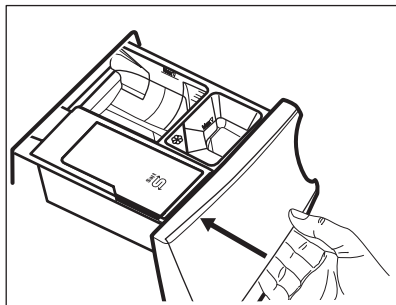

16.7 Cleaning the drain pump



WARNING!

Disconnect the mains plug from the mains socket.



Regularly check the drain pump filter and make sure that it is clean.

Clean the drain pump if:

- The appliance does not drain the water.
- The drum does not turn.
- The appliance makes an unusual noise because of the blockage of the drain pump.
- The message Check that the drain filter is not clogged pops up.



WARNING!

- Do not remove the filter while the appliance operates.
- Do not clean the pump if the water in the appliance is hot. Wait until the water cools down

Proceed as follows to clean the pump:

1. Open the pump cover.

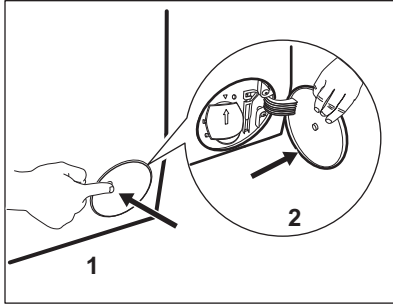

2. Place a suitable bowl below the drain pump access to collect the water that flows out.
3. Open the chute downwards. Always keep a rag nearby to dry up any water spillages when removing the filter.

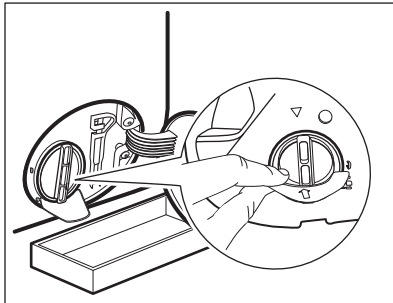

4. Turn the filter 180 degrees in anti-clockwise direction to open it, without removing. Let the water flow out.

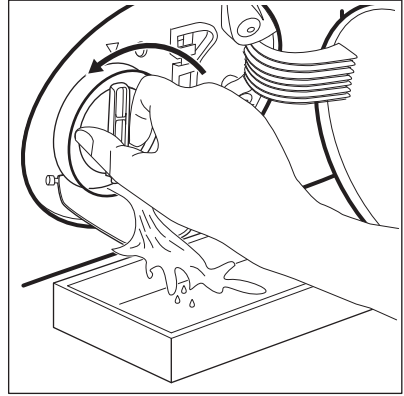

5. When the bowl is full of water, turn the filter back and empty the container.
6. Repeat the steps 4 and 5 until the water stops to flow out.
7. Turn the filter anti-clockwise to remove it.

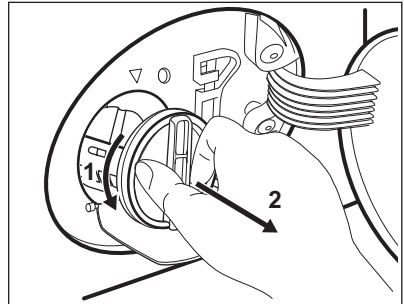

8. If it is necessary, remove fluff and objects from the filter recess.
9. Make sure that the impeller of the pump can rotate. If it does not rotate, contact the Authorised Service Centre.

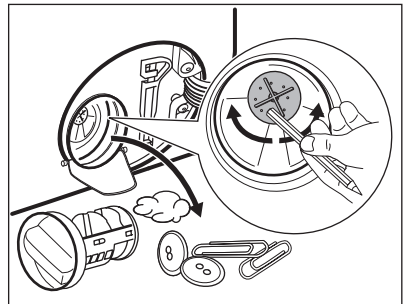

10. Clean the filter under the water tap.

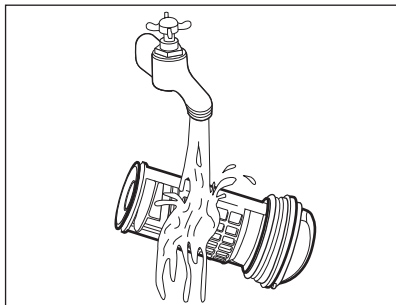

11. Put the filter back into the special guides by turning it clockwise. Make sure that you tighten the filter correctly to prevent leakages.

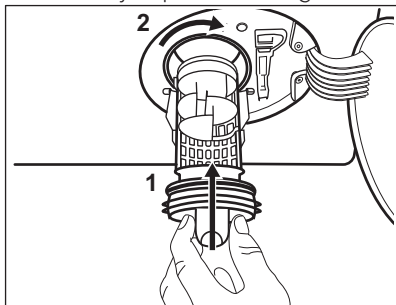

12. Close the pump cover.

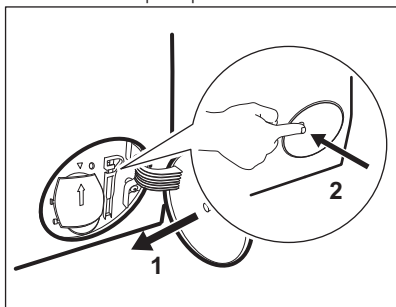

When you drain the water with the emergency drain procedure, you must activate the drain system again:

- a. Put 2 litres of water in the main wash compartment of the detergent dispenser.
- b. Start the programme to drain the water.

16.8 Cleaning the inlet hose and the valve filter

It is recommended to clean both the filters of the inlet hose and valve occasionally to remove any deposit, collected over the time:

1. Remove the inlet hose from the tap and clean the filter.

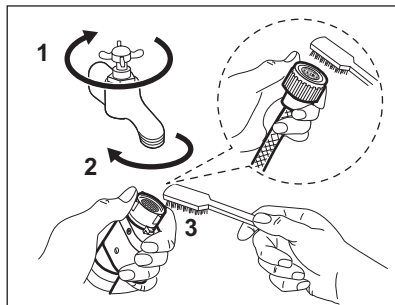

2. Remove the inlet hose from the appliance by loosening the ring nut.

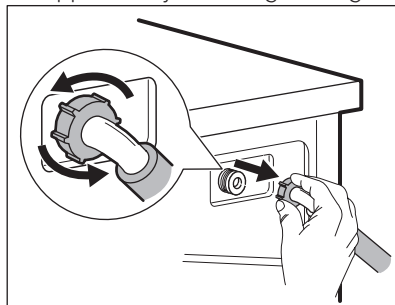

3. Clean the valve filter on the back of the appliance with a toothbrush.

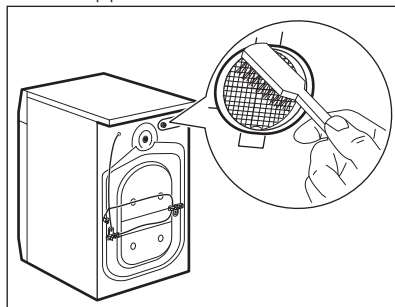

4. When you reconnect the hose to the back of the appliance, turn it left or right (not in vertical position) depending on the position of your water tap.

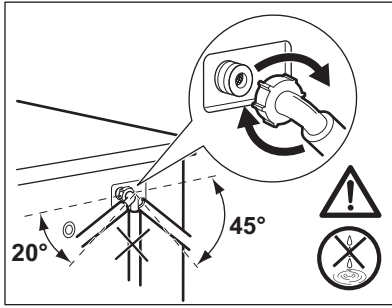

16.9 Emergency drain

If the appliance cannot drain the water, carry out the same procedure, described in 'Cleaning the drain filter' paragraph. If necessary, clean the pump.

When you drain the water with the emergency drain procedure, you must activate the drain system again:

1. Put 2 litres of water in the main wash compartment of the detergent dispenser.
2. Start the programme to drain the water.

17. TROUBLESHOOTING



WARNING!
Refer to Safety chapters.

17.1 Introduction



WARNING!
Deactivate the appliance before carrying out any check.

The appliance does not start or it stops during operation.

First try to find a solution to the problem (refer to the "Possible failures" table). If the problem persists, contact the Authorised Service Centre.

In case of major problems, the buzzer operates, an alarm message pops and the Start/Pause button may flash continuously, e.g.:

- **Check that the water inlet tap is open** - The appliance does not fill with water properly.

16.10 Frost precautions

If the appliance is installed in an area where the temperature can reach the values around 0° C or drop below, remove the remaining water from the inlet hose and the drain pump.

1. Disconnect the mains plug from the mains socket.
2. Close the water tap.
3. Put the two ends of the inlet hose in a container and let the water flow out of the hose.
4. Empty the drain pump. Refer to the emergency drain procedure.
5. When the drain pump is empty, install the inlet hose again.



WARNING!

Make sure that the temperature is higher than 0 °C before you use the appliance again. The manufacturer is not responsible for damages caused by low temperatures.

- **Check that the drain filter is not clogged** - The appliance does not drain the water.
- **Check that the door is properly closed** - The appliance door is open or not closed correctly. Please check the door!



If the appliance is overloaded, remove some items from the drum and/or keep the door pressed while pressing the Start/Pause button until the indicator

—□ stops flashing (see the picture below).

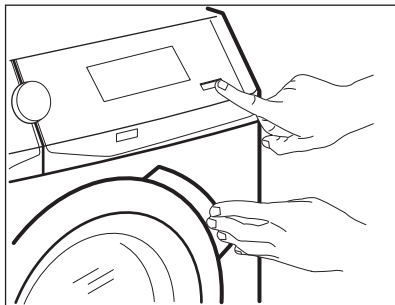

- **Programme will continue when electricity supply is stable** - The mains supply is unstable. Wait until the mains supply is stable.
- **A water leak has been detected** - The anti-flood device is on.

Disconnect the appliance and close the water tap. Contact the Authorised Service Centre.

- **Cleaning cycle recommended** - Run the **Machine Clean** programme as described in 'Programmes' chapter. If the cleaning programme is postponed, the message keeps on popping up during next uses until it is run.





If the cleaning programme is postponed, the message keeps on popping up during next uses until it is run.

17.2 Possible failures

Problem	Possible solution
The programme does not start.	<ul style="list-style-type: none"> • Make sure that the mains plug is connected to the mains socket. • Make sure that the appliance door is closed. • Make sure that there is no damaged fuse in the fuse box. • Make sure that the Start/Pause has been touched. • If the delay start is set, cancel the setting or wait for the end of countdown. • Deactivate the Child Lock function if it is on.
The appliance does not fill with water properly.	<ul style="list-style-type: none"> • Make sure that the water tap is open. • Make sure that the pressure of the water supply is not too low. For this information, contact your local water authority. • Make sure that the water tap is not clogged. • Make sure that the inlet hose has no kinks, damages or bends. • Make sure that the connection of the water inlet hose is correct. • Make sure that the filter of the inlet hose and the filter of the valve are not clogged. Refer to 'Care and cleaning'.
The appliance fills with water and drains immediately	<ul style="list-style-type: none"> • Make sure that the drain hose is in the correct position. The hose may be positioned too low. Refer to "Installation instruction".

Problem	Possible solution
The appliance does not drain the water.	<ul style="list-style-type: none"> • Make sure that the sink spigot is not clogged. • Make sure that the drain hose has no kinks or bends. • Make sure that the drain filter is not clogged. Clean the filter, if necessary. Refer to "Care and cleaning". • Make sure that the connection of the drain hose is correct. • Set the drain programme if you set a programme without drain phase. • Set the drain programme if you set an option which ends with water in the tub.
The spin phase does not operate or the washing cycle lasts longer than usual.	<ul style="list-style-type: none"> • Set the spin programme. • Make sure that the drain filter is not clogged. Clean the filter, if necessary. Refer to "Care and cleaning". • Adjust manually the items in the tub and start the spin phase again. This problem may be caused by balance problems.
There is water on the floor.	<ul style="list-style-type: none"> • Make sure that the couplings of the water hoses are tight and there is not water leakages. • Make sure that the water inlet hose and the drain hose have no damages. • Make sure you use the correct detergent and the correct quantity of it.
You cannot open the appliance door.	<ul style="list-style-type: none"> • Make sure that a washing programme that ends with water in tub, has been selected. • Make sure that the washing programme is finished. • Set the drain or the spin programme if there is water in the drum. • Make sure that the appliance receives electrical power. • This problem may be caused by a failure of the appliance. Contact the Authorised Service Centre. If you need to open the door, please read carefully "Emergency door opening".
The appliance makes an unusual noise and vibrates.	<ul style="list-style-type: none"> • Make sure the levelling of the appliance is correct. Refer to "Installation instruction". • Make sure that the packaging and/or the transit bolts are removed. Refer to "Installation instruction". • Add more laundry in the drum. The load may be too small.
The programme duration increases or decreases during programme execution.	<ul style="list-style-type: none"> • The ProSense function is able to adjust the programme duration according to the type and the laundry load size. Refer to "The ProSense load detection" in "Daily Use" chapter.

Problem	Possible solution
The washing results are not satisfactory.	<ul style="list-style-type: none"> • Increase the detergent quantity or use a different detergent. • Use special products to remove the stubborn stains before you wash the laundry. • Make sure that you set the correct temperature. • Decrease the laundry load. • Make sure that no other type of detergent has been poured the compartment . In this case, refer to "Eliminating detergent or other additives from salt compartment". • Make sure that no salt has been poured in the compartment . If it happens, run a rinse cycle or run the washing cycle again.
Too much foam in the drum during the washing cycle.	<ul style="list-style-type: none"> • Reduce the quantity of detergent.
Excessive consumption of salt.	<ul style="list-style-type: none"> • Check if the water softener has been set to act also during rinse phase. Refer to "How to set the water hardness level" in "The Water Softener (SoftWater Technology)" chapter.
The drum is empty and the display shows there is some weight in.	<ul style="list-style-type: none"> • Press the On/Off button to deactivate the appliance and activate it again to set a tare.
The drum is full but the display shows 0.0 kg.	<ul style="list-style-type: none"> • You loaded the laundry before activating the appliance. Press the On/Off button to deactivate the appliance. • Empty the drum and follow the necessary steps. (Refer to "Loading the laundry")

After the check, activate the appliance. The programme continues from the point of interruption.

If the problem occurs again, contact the Authorised Service Centre.

If the display shows other alarm codes. Deactivate and activate the appliance. If the problem continues, contact the Authorised Service Centre.

17.3 Emergency door opening

In case of power failure or functioning failure the appliance door remains locked. The washing programme continues when the power is restored. If the door remains locked in case of failure, it is possible to open it using the emergency unlock function.

Before opening the door:



CAUTION!

Risk of burns! Make sure that the water temperature is not too high and the laundry is not hot. If necessary, wait until they cool down.



CAUTION!
Risk of injury! Make sure that the drum is not rotating. If necessary, wait until the drum stops rotating.



Make sure that the water level inside the drum is not too high. If necessary, proceed with an emergency drain (refer to «Emergency drain» in «Care and cleaning» chapter).

To open the door, proceed as follows:

1. Press the On/Off button to switch the appliance off.
2. Disconnect the mains plug from the mains socket.
3. Open the filter flap.
4. Pull twice the emergency unlock trigger downward and open the appliance door.

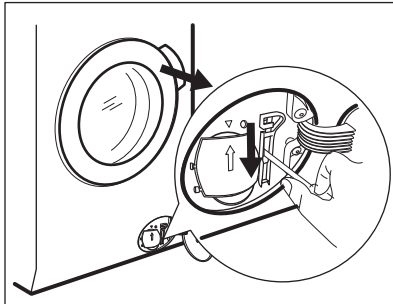

5. Take out the laundry and then close the appliance door.

6. Close the filter flap.



17.4 Eliminating detergent or other additives from salt compartment

Any type of detergent and additives inadvertently poured in the compartment  must be eliminated completely.

If this happens, please proceed as follows:

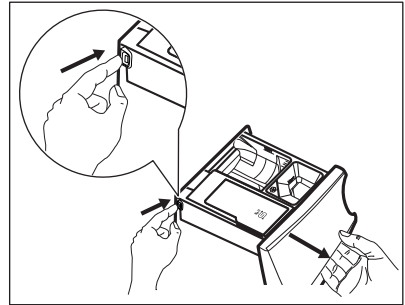
1. Pull the drawer out.



2. Eliminate any trace of detergent or additive and clean the compartment thoroughly.
3. Insert the drawer back and pour salt  in the compartment .
4. Close the drawer.
5. Run a cotton or synthetic cycle, without reducing time, to restore the water softener function.

18. TECHNICAL DATA

Dimension	Width/ Height/ Depth/ Total depth	600 mm/ 850 mm/ 630 mm/ 660 mm
Electrical connection	Voltage	220 - 240 V
	Overall power	2200 W
	Fuse	10 A
	Frequency	50 Hz

Level of protection against ingress of solid particles and moisture ensured by the protective cover, except where the low voltage equipment has no protection against moisture		IPX4
Water supply pressure	Minimum	0,5 bar (0,05 MPa)
	Maximum	8 bar (0,8 MPa)
Water supply ¹⁾		Cold water
Maximum Load	Cotton	10 kg
Spin Speed	Maximum	1600 rpm

¹⁾ Connect the water inlet hose to a water tap with a 3/4" thread.

19. ACCESSORIES

19.1 Available in www.aeg.com/shop or from authorised dealer

i Only appropriate accessories approved by AEG ensure the safety standards of the appliance. If unapproved parts are used, any claims will be invalidated.

19.2 Fixing plate kit

If you install the appliance on a plinth, secure the appliance with the fixing plates.

Read carefully the instructions supplied with the accessory.

19.3 Stacking kit

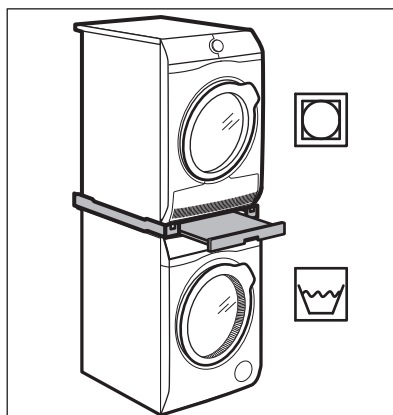

The tumble dryer can be stacked on the top of the washing machine **only by using the correct stacking kit manufactured and approved by AEG.**

i Verify the compatible stacking kit by checking the depth of your appliances.

The stacking kit can be used only with the appliances specified in the leaflet provided with the accessory.

Read carefully the instructions supplied with the appliance and with the accessory.



WARNING!

Do not put the tumble dryer under the washing machine.

19.4 Pedestal with the drawer

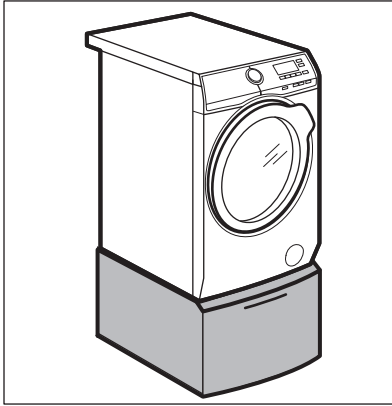

To raise your appliance and make loading and unloading laundry easier.

The drawer can be used for laundry storage e.g.: towels, cleaning products and more.

Read carefully the instructions supplied with the accessory.

21. ENVIRONMENTAL CONCERNS

Recycle materials with the symbol . Put the packaging in relevant containers to recycle it. Help protect the environment and human health by recycling waste of electrical and electronic appliances. Do not dispose of

appliances marked with the symbol  with the household waste. Return the product to your local recycling facility or contact your municipal office.

AEG Warranty

FOR SALES IN AUSTRALIA AND NEW ZEALAND
ALL AEG BRANDED APPLIANCES

This document sets out the terms and conditions of the product warranties for AEG Appliances. It is an important document. Please keep it with your proof of purchase documents in a safe place for future reference should there be a manufacturing defect in your Appliance. This warranty is in addition to other rights you may have under the Australian Consumer Law.

1. In this warranty:

- (a) 'ACL' or 'Australian Consumer Law' means Schedule 2 to the Competition and Consumer Act 2010;
- (b) 'Appliance' means any Electrolux product purchased by you and accompanied by this document;
- (c) 'ASC' means Electrolux's authorised serviced centres;
- (d) 'AEG' is the brand controlled by Electrolux Home Products Pty Ltd of 163 O'Riordan Street, Mascot NSW 2020, ABN 51 004 762 341 in respect of Appliances purchased in Australia and Electrolux (NZ) Limited (collectively "Electrolux") of 3-5 Niall Burgess Road, Mount Wellington, in respect of Appliances purchased in New Zealand;
- (e) 'Warranty Period' means the period specified in clause 3 of this warranty;
- (f) 'you' means the purchaser of the Appliance not having purchased the Appliance for re-sale, and 'your' has a corresponding meaning.

2. Application: This warranty only applies to new Appliances, purchased and used in Australia or New Zealand and is in addition to (and does not exclude, restrict, or modify in any way) other rights and remedies under a law to which the Appliances or services relate, including any non-excludable statutory guarantees in Australia and New Zealand.

3. Warranty Period: Subject to these terms and conditions, this warranty continues for in Australia for a period of 60 months and in New Zealand for a period of 60 months, following the date of original purchase of the Appliance.

4. Repair or replace warranty: During the Warranty Period, Electrolux or its ASC will, at no extra charge if your Appliance is readily accessible for service, without special equipment and subject to these terms and conditions, repair or replace any parts which it considers to be defective. Electrolux may, in its absolute discretion, choose whether the remedy offered for a valid warranty claim is repair or replacement. Electrolux or its ASC may use refurbished parts to repair your Appliance. You agree that any replaced Appliances or parts become the property of Electrolux.

5. Travel and transportation costs: Subject to clause 7, Electrolux will bear the reasonable cost of transportation, travel and delivery of the Appliance to and from Electrolux or its ASC. Travel and transportation will be arranged by Electrolux as part of any valid warranty claim.

6. Proof of purchase is required before you can make a claim under this warranty.

7. Exclusions: You may not make a claim under this warranty unless the defect claimed is due to faulty or defective parts or workmanship. This warranty does not cover:

- (a) light globes, batteries, filters or similar perishable parts;
- (b) parts and Appliances not supplied by Electrolux;

- (c) cosmetic damage which does not affect the operation of the Appliance;
- (d) damage to the Appliance caused by:
 - (i) negligence or accident;
 - (ii) misuse or abuse, including failure to properly maintain or service;
 - (iii) improper, negligent or faulty servicing or repair works done by anyone other than an Electrolux authorised repairer or ASC;
 - (iv) normal wear and tear;
 - (v) power surges, electrical storm damage or incorrect power supply;
 - (vi) incomplete or improper installation;
 - (vii) incorrect, improper or inappropriate operation;
 - (viii) insect or vermin infestation;
 - (ix) failure to comply with any additional instructions supplied with the Appliance;

In addition, Electrolux is not liable under this warranty if:

- (a) the Appliance has been, or Electrolux reasonably believes that the Appliance has been, used for purposes other than those for which the Appliance was intended, including where the Appliance has been used for any non-domestic purpose;
- (b) the Appliance is modified without authority from Electrolux in writing;
- (c) the Appliance's serial number or warranty seal has been removed or defaced.

8. How to claim under this warranty: To enquire about claiming under this warranty, please follow these steps:

- (a) carefully check the operating instructions, user manual and the terms of this warranty;
- (b) have the model and serial number of the Appliance available;
- (c) have the proof of purchase (e.g. an invoice) available;
- (d) telephone the numbers shown below.

9. Australia: For Appliances and services provided by Electrolux in Australia: Electrolux goods come with guarantees that cannot be excluded under the Australian Consumer Law. You are entitled to a replacement or refund for a major failure and for compensation for any other reasonably foreseeable loss or damage. You are also entitled to have the Appliance repaired or replaced if the Appliance fails to be of acceptable quality and the failure does not amount to a major failure. 'Acceptable quality' and 'major failure' have the same meaning as referred to in the ACL.

10. New Zealand: For Appliances and services provided by Electrolux in New Zealand, the Appliances come with a guarantee by Electrolux pursuant to the provisions of the Consumer Guarantees Act, the Sale of Goods Act and the Fair Trading Act. Where the Appliance was purchased in New Zealand for commercial purposes the Consumer Guarantee Act does not apply.

11. Confidentiality: You accept that if you make a warranty claim, Electrolux and its agents including ASC may exchange information in relation to you to enable Electrolux to meet its obligations under this warranty.

Important Notice

Before calling for service, please ensure that the steps listed in clause 8 above have been followed.

<p>FOR SERVICE or to find the address of your nearest authorised service centre in Australia PLEASE CALL 1300 363 664 OR EMAIL customercare@aegaustralia.com.au For the cost of a local call (Australia only)</p>	<p>SERVICE AUSTRALIA AEG aeg.com.au</p>	<p>FOR SPARE PARTS or to find the address of your nearest spare parts centre in Australia PLEASE CALL 13 13 50 OR EMAIL customercare@aegaustralia.com.au For the cost of a local call (Australia only)</p>
<p>FOR SERVICE or to find the address of your nearest authorised service centre in New Zealand PLEASE CALL 0800 234 234 OR EMAIL customercare@electrolux.co.nz (New Zealand only)</p>	<p>SERVICE NEW ZEALAND AEG aegnewzealand.co.nz</p>	<p>FOR SPARE PARTS or to find the address of your nearest spare parts centre in New Zealand PLEASE CALL 0800 10 66 20 OR EMAIL customercare@electrolux.co.nz (New Zealand only)</p>

